

**GURU NANAK KHALSA COLLEGE FOR WOMEN
GUJARKHAN CAMPUS, MODEL TOWN, LUDHIANA**



**Supporting Document
(2023-2024)**

***7.1.6 Quality audits on environment and energy
are regularly undertaken by the institution***

**Dr. Maneeta Kahlon
Principal**

**Dr. MANEETA KAHLON
Principal
G.N.Kh. College for Women
Gujarkhan Campus, Model Town,
Ludhiana.**

ENVIRONMENT AUDIT

An environmental audit is a kind of assessment meant to find implementation gaps in management systems and environmental compliance, as well as associated remedial measures. They carry out a comparable function to financial audits in this way.

OBJECTIVES OF THE AUDIT: A methodical, recorded, periodic, and objective assessment of the effectiveness of environmental organization, management, and equipment is called quality auditing. Its goal is to assist protect the environment by:

- i. Enabling environmental practice management and control.
- ii. Evaluating adherence to different policies, including fulfilling legal obligations.
- iii. Making students aware of the escalating environmental problems.

UNDER THIS, ENERGY AUDIT, GREEN AUDIT AND WATER AUDIT WERE CARRIED OUT IN COLLEGE, REPORTS OF WHICH HAVE BEEN ATTACHED.

Additionally, **ECO CLUB** in collaboration with **GREEN CLUB** has conducted a number of activities in college to promote environment sustainability and spread awareness about it.

About Eco Club

Eco-club is a voluntary group of students and staff which promotes the environmental awareness, conservation of natural resources, control of pollution, reduction of plastic usage, planting of trees, water management etc. It also encourages the students in clean and green consciousness through various innovative methods. The Eco-club takes the support of Biodiversity Cell, NCC and NSS Unit for increasing the greenery of the campus and other eco-friendly activities.

Objectives of Eco club

- To encourage the students to plant more number of trees in the college campus, their homes and villages for increasing the green cover.
- To conduct Clean and Green, Swachhta Mission activities in the college campus.
- To create awareness on various environmental issues like Climate Change, Global Warming, Greenhouse effect, Acid rains, Pollution, Environmental movements and laws.
- To promote culture of Conservation of natural resources, Water management, Rain water harvesting and Solid Waste management.
- To educate students about reducing the usage of plastic, polythene bags and importance of 3Rs (Reduce, Reuse and Recycle).

MAJOR ACTIVITIES

- Organizing seminars, workshops, guest lectures on various environmental issues.
- Conducting tree plantation drives.
- Campaign against usage of plastic and polythene made articles and bags.
- Making Eco-friendly items with waste and used materials.
- Encouraging home gardens and departmental indoor gardens.
- Promoting Clean and Green, Swachhta Mission activities in the college.

ONLINE WORKSHOP ON SUSTAINABLE PRACTICES AND MISSION LIFE ON WORLD ENVIRONMENT DAY

June 02, 2023

In collaboration with Mission Life, an initiative of the Ministry of Environment, Forestry and Climate Change, the college organized an Online Workshop on Sustainable Practices and Mission Life, on the occasion of World Environment Day on June 02, 2023. The resource person for the discussion was Dr. Devinder Kaur Kocher, Prof. (Zoology) PAU, Ludhiana. She talked about the various types of mosquitoes and the fevers which are spread by these mosquitoes. She further told about the various preventive measures which should be taken to safeguard ourselves from the deadly mosquito bites. The lecture was presented in the form of a PPT. The students as well as teachers were the participants of the discussion forum.



WORLD CYCLE DAY

June 03, 2023

World Cycle Day was observed in the college campus on June 03. It is celebrated annually on June 3 to promote the benefits of cycling and raise awareness about the importance of bicycles as a sustainable mode of transportation.



REUSING AND REPURPOSING IN ORDER TO PROMOTE ENVIRONMENTAL SUSTAINABILITY

June 03, 2023

Reusing papers in printers is a simple yet effective way to promote environmental sustainability, save money, and cultivate a mindful approach to resource consumption. It helps in contributing to the conservation of forests, reducing waste, and minimizing the ecological footprint of the paper industry.

Instead of constantly purchasing new paper, we utilize the reverse side or unused portions of previously printed papers, reducing expenses over time.



WORLD ENVIRONMENT DAY

June 05, 2023

Under the aegis of IQAC, the NCC wing of Guru Nanak Khalsa College for Women, Ludhiana celebrated 'World environment day'. On this day, students pledged to collectively work towards protecting Mother Nature. With the aim that multiple small steps can bring in a major change, students also planted a plant, to contribute in making our planet greener and healthier.

More than 25 cadets took part in this activity.

The staff of GNKCW attended the virtual meeting on celebrations of World Environment Day on June 5, 2023 organized by the Ministry of Education.

The staff and students undertook 'Lifestyle for environment' pledge on mygov web portal to consciously participate in environmental lifestyle and inculcate long-term environment-friendly habits.





GPS Map Camera

Ludhiana, Punjab, India

Model Town, Ludhiana, GNIMT Lane, Pritm Nagar, Model Town,
Ludhiana, Punjab 141002, India

Lat 30.886783°

Long 75.843465°

05/06/23 10:55 AM GMT +05:30

Google

WORLD FOOD SAFETY DAY

June 07, 2023

World Food Safety Day' was observed on June 7, 2023 on the theme "Food Standards Save Lives" as given under G20.

12 students participated in the campaign with an aim of raising awareness about food safety measures adopted at household level to check adulteration so as to reduce foodborne diseases. Mrs. Shikha Kalra and Mrs. Amarpreet Kaur demonstrated different techniques of testing food adulteration in the processed and unprocessed foods like Milk and Desi Ghee which are locally available in the market.



WORLD BLOOD DONOR DAY

June 13, 2023

Blood Donor Day serves as a reminder of the critical need for blood donation and the profound impact it can have on saving lives.

On this occasion, 48 cadets took part in a Poster Making competition to spread awareness about blood donation. This activity was conducted by NCC Caretaker officer Ms. Asha.



PREPARATIONS FOR INTERNATIONAL DAY OF YOGA

June 20, 2023

The preparations for International Day of Yoga have officially commenced on June 20, 2023 with the aim of creating a serene and invigorating atmosphere in the college campus, as per the directives of Ministry of Education, Government of India, under the theme 'Vasudhaiva Kutumbakam'

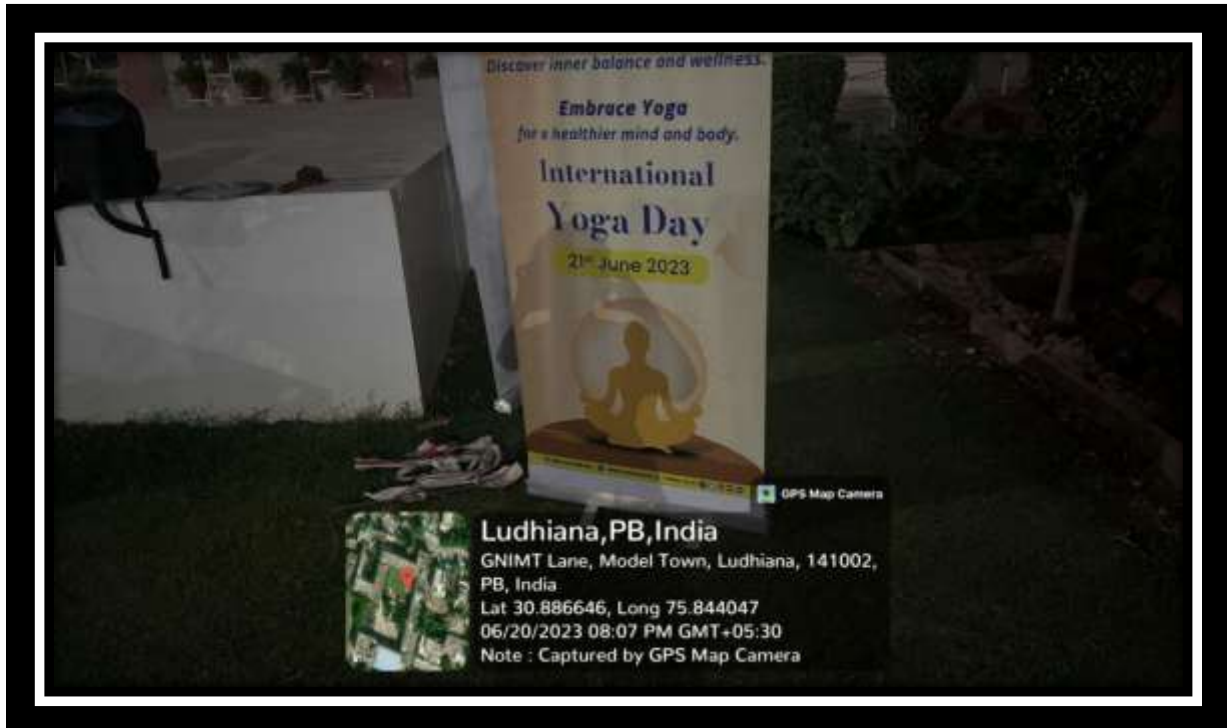

QUIZ COMPETITION ON THE OCCASION OF INTERNATIONAL DAY OF YOGA

June 21, 2023

The staff and students of GNKCW participate in a Quiz Competition to commemorate the International Day of Yoga on mygov web portal to remind people across the globe about the benefits of Yoga, and to build enduring public interest in Yoga by highlighting its importance and contributions to public health.

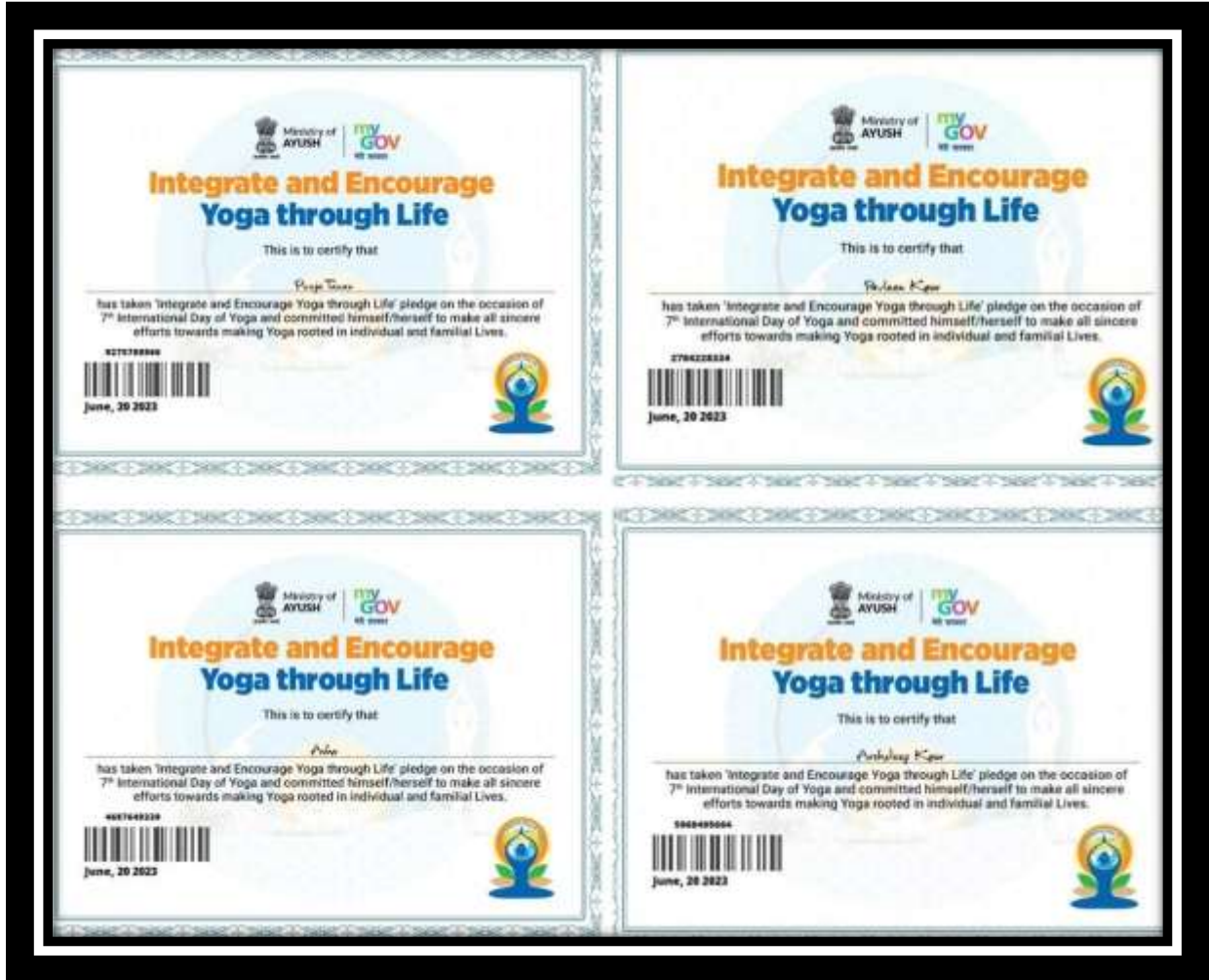

INTERNATIONAL PLASTIC BAG FREE DAY

July 04, 2023

The college observed the International Plastic Bag Free on July 04, 2023. This day is celebrated annually on July 3 to create awareness about the hazardous effects of single-use plastic bags on the environment. The day also serves as a reminder for individuals and communities globally to decrease their reliance on plastic bags and look for sustainable solutions as an alternative.



WORLD POPULATION DAY

July 11, 2023

The college observed World Population Day on July 11, 2023. Ms. Seema Dua, Head of the Department of Economics informed the challenges and consequences associated with global population growth. She elaborated on the theme of the World Population Day 2023 – Unleashing the Power of gender equality: Uplifting the voices of women and girls to unlock our world's infinite possibilities. Dr. Madhu Dhawan, Head of the Department of Sociology discussed the pertinent issues of gender injustice with rising population of the world. She emphasized that women who constitute half of the global population, are often ignored in population policies.



WORLD HEPATITIS DAY

July 28, 2023

In the awareness lecture organized on the occasion of World Hepatitis Day on July 28, 2023, the Club Coordinators, Dr. Nidhi and Ms. Daisy Wadhwa shed light on the significance of World Hepatitis Day and the importance of preventing and controlling this global health concern. Students were informed about the different types of Hepatitis, its symptoms, and the necessary steps to mitigate its impact on individual and community health.



WORLD NATURE CONSERVATION DAY

Under the aegis of IQAC, the Eco Club in collaboration with SES REC, Guru Nanak Khalsa College for Women, Gujarkhan Campus, celebrated World Nature Conservation Day on July 28, 2023.

Under this activity, students were told about the significance of Nature and how human beings should act more responsibly to conserve our Nature. A number of students from various classes participated in the activity and shared their views on conservation of nature. On this occasion, a pledge was also taken where the students vowed to plant trees for their future generations.





ORGAN DONATION DAY

August 03, 2023

Organ Donation Day was observed in the college on August 03,2023. This day is observed to raise awareness about the importance of donating organs after death to save more lives.

NSS Program Officers Dr. Neetu Prakash and Mrs. Satwant Kaur discussed with the students about the importance of organ donation. NSS volunteers took pledge on online as well as offline mode.



MARATHON CONDUCTED BY PUNJAB STATE AIDS CONTROL SOCIETY

August 11, 2023

Volunteers of Youth and Red Ribbon Clubs participated in an awareness drive on HIV/AIDS and Drug abuse held on August 11, 2023. During this awareness program, a marathon run was organized at SCD Government College, Ludhiana by the **Director of Youth Services, Ludhiana in collaboration with Punjab State AIDS Control Society**. The marathon started from SCD Government College at 6:00am and concluded at Guru Nanak Stadium. The following students participated in this event:

1. Rupinder Kaur B.Com- 2nd Year/ 221126
2. Sonali Rai B.Com- 3rd Year/ 211063
3. Deepshikha B.Com- 3rd Year/211069
4. Ishmeet Kaur BCA- 2nd Year/ 221922
5. Sameepya Sharma BCA- 2nd Year/ 221935



SWACHHATA SARVEKSHAN 2023

August 14, 2023

Eco / Green club of the college participated in *Swachhata Sarvekshan 2023* in collaboration with a team from Municipal Corporation Ludhiana. Students and faculty members expressed their views on Swachhata ratings through an app regarding the sanitation and other amenities in Ludhiana.



MEDICAL CAMP IN THE VILLAGE JASSOWAL

August 25, 2023

The team of the college organized a medical camp in the village Jassowal on August 25, 2023. A team of doctors comprising Dr. Ashrita Singh from Fortis hospital Ludhiana, Dr. Anurag Navik and Dr. Shiv and Mr. Akhilesh Singh from Shiv Ram Hospital, conducted free check-ups of blood pressure, sugar level tests of the village residents and prescribed them medicines. Residents also discussed various personal diseases like allergies, fungal infection, weakness, stomach problems etc, also prescribed and distributed them medicine.

A counseling session was also organized to discuss the importance of cleanliness and hygiene for disease free health.



SWACHHTA PAKHWADA PROGRAM - OATH TAKING CEREMONY

Under the aegis of IQAC, Guru Nanak Khalsa College for Women initiated the Swachhta Pakhwada Program. The program is a part of Swachhta Abhiyaan which started with the objective of bringing a fortnight of intense focus on the issues and practices of Swachhata. Under this program, an oath taking ceremony was held on September 1, 2022 in the college premises. The students took the pledge to keep their surroundings and themselves clean.



SWACHHTA PAKHWADA PROGRAM – SENSITIZATION AND AWARENESS

The theme of the program is sensitization and awareness in the rural areas. Various activities are organized by IQAC and NSS, Unit of the college in collaboration with Department of Home Science and Swachta Pakhwada.



International Day for the Preservation of Ozone Layer

International Day for the Preservation of Ozone Layer observed at GNKCW

Under the aegis of IQAC, the Social Entrepreneurship, Swachhta and Rural Engagement Cell and Eco club of Guru Nanak Khalsa College for Women, Model Town, Ludhiana, screened a documentary film related to ozone layer depletion on occasion of International Day for the Preservation of Ozone Layer on September 16, 2023.

The day is celebrated commemorating the date when the Montreal Protocol on substances that deplete the Ozone Layer was signed in 1987. The purpose of this activity was to raise awareness among students to save the depletion of ozone layer. Dr. Parveen Arora explained the students about various reasons of ozone depletion and encouraged them to limit the use of air conditioners for its prevention.





CLEANLINESS DRIVE

October 1, 2023

Under the aegis of IQAC, Eco club of Guru Nanak Khalsa College for Women observed Ek Tariq, Ek Ghanta under Swachhta Pakhwada Cleanliness Drive Program on October 1, 2023. The program is a part of Swachhta Abhiyaan which started with the objective of bringing a fortnight of intense focus on the issues and practices of Swachhata. Under this drive, volunteers, Faculty members and supporting staff participated in the cleanliness activities in the college premises.



WORLD WETLAND DAY

February 02, 2024

Under the aegis of IQAC, the Department of Public Administration and Eco Club of Guru Nanak Khalsa College for Women, Ludhiana, celebrated World Wetlands Day. An interactive session was organized by Dr. Parveen Arora in which students were invited to participate and express their opinions about what they want to change in their lives to save the environment from global warming. Dr. Parveen Arora discussed the impact of climate change as well as the ways to make the planet more sustainable and safe for migratory birds and other species.



VISIT TO NEHRU ROSE GARDEN

February 3, 2024

On the occasion of 3rd Environment Conservation Fair

PG Department of English of Guru Nanak Khalsa College for Women organized a Visit to Nehru Rose Garden on the occasion of 3rd Environment Conservation Fair on **February 3, 2024** for the students of MA 2nd and 4th semester. The students visited the fair where a number of stalls dealing with organic food materials, plants natural made fiber and other renewable commodities were displayed. The students were accompanied by Mrs. Gagneet Pal Kaur, Assistant Professor and Mrs. Kavita Kuplish (English). The students enjoyed this visit which highlighted the problems surfacing in the environment and how they can be tackled by making slight changes in our lifestyle.

The dedicated volunteers of the NSS Unit at Guru Nanak Khalsa College for Women in Model Town, Ludhiana, gained valuable insights by actively participating in an enlightening online quiz. This quiz was thoughtfully crafted to heighten awareness about traffic rules, with the overarching goal of fostering safer roads and streets in India. The emphasis was on imparting knowledge about accident prevention and minimizing injuries on the road. Within this post, samples of the online quiz certificates, showcasing the volunteers' commitment are shared.



SAFER INTERNET DAY

February 6, 2024

Under the aegis of the Internal Quality Assurance Cell, the Department of Computer Science and Applications at Guru Nanak Khalsa College for Women, Model Town, Ludhiana, commemorated Safer Internet Day on **February 6, 2024**, with a focus on fostering awareness about internet safety.

To engage students creatively, the department organized Logo Designing and Social Media Post Creation competitions aligned with the theme of 'Together for a better Internet'. Dr. Kirti Dhawan, Head of the Department of Journalism and Mass Communication, served as the judge for the competitions, evaluating the innovative entries submitted by the participants.



WORLD SIKH ENVIRONMENT DAY

March 14, 2024

Under the aegis of Internal Quality Assurance Cell, Greenery Committee of Social Entrepreneurship, Swachhta & Rural Engagement Cell (SES-REC) MGNCRE, New Delhi of Guru Nanak Khalsa College for Women celebrated World Sikh Environment Day on **March 14, 2024**. Under these celebrations, the gardens of the college are being taken care of by the able team of the gardeners. The college has been participating in various flower show competitions held at various places in the city such as Rose Garden, Punjab Agricultural University and Gurudwara Singh Sabha, Sarbha Nagar. The college has won numerous prizes under various categories.



WORLD SPARROW DAY

March 20, 2024

Under the auspices of the Internal Quality Assurance Cell (IQAC), the Eco Club of Guru Nanak Khalsa College for Women in Ludhiana commemorated World Sparrow Day with a fervent commitment to biodiversity awareness. Students took proactive measures by distributing birdfeed across the garden and ensuring ample water availability in pots, fostering a nurturing environment for the delicate sparrows.



WORLD WATER DAY

March 22, 2024.

Focus on the theme 'Leveraging Water for Peace', World Water Day was Celebrated by the Water management team of Guru Nanak Khalsa College for Women , under MGNCRE, Ministry of Education, Government of India .

Awareness lecture was conducted in order to sensitize students regarding the various actions that can be taken to tackle the water and sanitation crisis. Lecture also emphasized on the value of fresh water for the environment and its need for sustainable development. A poster making competition was organized by the Department of Fine Arts in which students from different classes participated.



World Earth Day

April 22, 2024

Under the aegis of Internal Quality Assurance Cell, Eco Club and NCC Unit of Guru Nanak Khalsa College for Women celebrated World Earth Day. The theme for the celebration was “Plants vs Plastic”

On this occasion, students marked a unique idea by growing plants in the waste plastic articles like bottles, plates, glasses, bowls etc. A Road rally was also organized to save the earth and water for next generations under the supervision of Lt. Sukhjit Kaur. While addressing the students, Dr. Parveen Arora highlighted the major threats and challenges for our earth and how society can play an important role in preserving our earth for our coming generations.



INTERNATIONAL BIODIVERSITY DAY AND WORLD ENVIRONMENT DAY

(DAY-I)

May 22-29, 2024

Under the aegis of IQAC, the Eco Club of Guru Nanak Khalsa College for Women Model Town Ludhiana is celebrating International Biodiversity Day and World Environment Day in collaboration with Punjab Biodiversity Board (PBB). The celebrations began today, **May 22, 2024**, with a Tree Plantation Drive organized by the students.



(DAY-II)

Under the aegis of IQAC, Guru Nanak Khalsa College for Women, Ludhiana, in collaboration with the Punjab Biodiversity Board and the Punjab State Council of Science and Technology, supported by the National Biodiversity Authority and the Ministry of Environment, Forest, and Climate Change, Government of India, organized an Environmental Education Program. Students and faculty members, along with Principal Dr. Maneeta Kahlon, visited the Herbal Garden, where more than 30 varieties of herbs, spices, and medicinal plants are grown and maintained successfully. Mrs. Gagneet Pal Kaur explained the various uses of herbs and spices.



(DAY-III)

Under the aegis of IQAC, the Eco Club of Guru Nanak Khalsa College for Women, Ludhiana, organized an Article Writing Competition on the topic of "Conservation of Environment—A Student's Viewpoint", which saw participation from 22 students. All participants will be felicitated on May 29th, 2024, by the Resource Person, with winners receiving trophies.



(DAY-IV)

Under the aegis of the Internal Quality Assurance Cell (IQAC), Guru Nanak Khalsa College for Women in Ludhiana collaborated with the Punjab Biodiversity Board and the Punjab State Council of Science and Technology. This collaboration was supported by the National Biodiversity Authority and the Ministry of Environment, Forest, and Climate Change, Government of India. A certificate distribution ceremony had been organized to honor volunteers who have been actively spreading the message of environmental conservation.



(DAY-V)

Under the aegis of the Internal Quality Assurance Cell (IQAC), Guru Nanak Khalsa College for Women in Ludhiana collaborated with the Punjab Biodiversity Board and the Punjab State Council of Science and Technology. This collaboration was supported by the National Biodiversity Authority and the Ministry of Environment, Forest, and Climate Change, Government of India.

A thought-sharing session was organized on global warming and its impact on biodiversity. Students shared their views regarding the degradation of the environment and proposed solutions such as tree plantation, rainwater harvesting, sustainable development, and creating a pollution-free environment.



(DAY-VI)

Under the aegis of the Internal Quality Assurance Cell (IQAC), Guru Nanak Khalsa College for Women in Ludhiana collaborated with the Punjab Biodiversity Board and the Punjab State Council of Science and Technology. This collaboration was supported by the National Biodiversity Authority and the Ministry of Environment, Forest, and Climate Change, Government of India.

A workshop on Best out of Waste was organized to promote the principles of reusing, reducing, and recycling waste material. Students made beautiful articles like earrings, flower vase from cold drink cans, installation from newspapers, envelopes, painting decorations from empty paint buckets, decorative items from empty milk bottles and other useful items from waste material.



(DAY-VII)

Under the aegis of the Internal Quality Assurance Cell (IQAC), Eco Club and the Department of Fine Arts of Guru Nanak Khalsa College for Women in Ludhiana collaborated with the Punjab Biodiversity Board and the Punjab State Council of Science and Technology. This collaboration received support from the National Biodiversity Authority and the Ministry of Environment, Forest, and Climate Change, Government of India.

The prize distribution ceremony for the Poster Making and Slogan Writing Competition on environmental conservation was a vibrant celebration of creativity and commitment to our planet. Following the ceremony, a signing campaign commenced from May 24th to May 29th, 2024, inviting attendees to pledge their support for environmental protection. With pens in hand and determination in their hearts, each signature symbolized a promise to embrace eco-friendly practices and advocate for positive change.



ENERGY AUDIT

INTRODUCTION

PREFACE:

The availability and use of energy are critical drivers of economic growth and development in any country, leading to an increasing demand for energy. However, the global energy crisis, rising costs, concerns over environmental protection, and the competitive nature of open markets present significant challenges for Indian colleges to survive and thrive.

One of the most accessible strategies for overcoming these challenges is **Energy Conservation**, which not only helps protect the environment but also reduces costs through strategic energy management. This approach emphasizes energy cost reduction, preventive maintenance, and quality control programs, turning conservation concepts into tangible solutions by incorporating feasible, tech-driven strategies within a set timeframe.

Energy conservation is a global priority. India's energy policy advocates for energy savings, with the Energy Conservation Act of 2001 highlighting the government's authority to enforce the efficient use and conservation of energy.

The study was conducted by a team comprising of Dr. Arvind Dhingra, Pf. Karanbir Singh, Pf. Sukhpal Singh and S. Daljeet Singh, and is valid till 3 years. This study by has analysed the power system parameters at the source, distribution panels, and various equipment. It also examined the illumination levels in different areas of **Guru Nanak Khalsa College for Women**, where the study was permitted. The research identified key problem areas, barriers to optimal use of resources, and proposed cost-effective solutions. Additionally, it offers recommendations for improving system performance with quick payback, focusing on cost-effective and efficient solutions.

OBJECTIVES:

The goal of this study is to evaluate the overall efficiency of various systems and determine the specific energy consumption patterns of the public building. Based on the findings of the energy audit, the study aims to provide recommendations for potential energy-saving opportunities.

THE KEY AREAS OF FOCUS INCLUDE:

- Electrical system details
- Building usage and occupancy
- Features of energy supply
- Information on systems, equipment, and appliances
- Power quality analysis

COLLEGE OVERVIEW

Guru Nanak Khalsa College for Women, located in Ludhiana, was founded in 1969 to commemorate the 500th anniversary of Guru Nanak Dev Ji. The college currently offers a variety of programs, including two additional courses, several postgraduate options, and a wide range of undergraduate degrees. The institution is committed to maintaining an environmentally-friendly campus. Throughout its history, the college has prioritized sustainability and the preservation of eco-friendly practices. The campus is designed with a focus on green space, with a substantial portion of the land dedicated to plantations and open areas, which contribute to enhancing and sustaining the overall campus environment.



STUDY TEAM

NAME	DESIGNATION
Dr. Parveen Arora	Assistant Professor (Public administration)
Ms. Surjit Kaur	Assistant Professor (OMSP)
Dr. Shikha Bajaj	Assistant Professor (Fashion Designing)
Ms. Kritika	Assistant Professor (English)
Ms. Sandeep	Assistant Professor (History)
Ms. Rachna	Assistant Professor (Punjabi)

RESPONSIBILITIES OF AUDIT TEAM

1. Establish an energy conservation cell within the firm with management's consent about the mandate and task of the cell.
2. Initiate activities to improve monitoring and process control to reduce energy costs.
3. Analyze equipment performance with respect to energy efficiency.
4. Ensure proper functioning and calibration of instrumentation required to assess level of energy consumption directly or indirectly.
5. Prepare information material and conduct internal workshops about the topic for other staff.
6. Improve disaggregating of energy consumption data down to shop level or profit center of a firm.
7. Establish a methodology how to accurately calculate the specific energy consumption of various products/services or activity of the firm.
8. Develop and manage training programme for energy efficiency at operating levels.
9. Co-ordinate nomination of management personnel to external programs.
10. Develop integrated system of energy efficiency and environmental upgradation, Wide internal & external networking.
11. Co-ordinate implementation of energy audit/efficiency improvement projects through external agencies.
12. Establish and/or participate in information exchange with other energy managers of the same sector through association.

FINDINGS

1. Fans were still ON in a classroom at first floor even after the class was over.



2. Faulty light fittings which were found in corridor.



SUGGESTIONS

1. Avoid putting equipment of standby mode.
2. Fans should be turned off after the class is over.
3. Faulty light fittings should be replaced.
4. Use outside breeze when possible, should the air conditioner be turned off completely to minimize the cost of electricity.
5. Always close door when entering/exiting an air-conditioned room (put a notice on the front and back of the door as a reminder)

IMPLEMENTATIONS

1. Blowers and heaters were allowed to run only in the month of December.
2. Air conditioners were allowed to be used till September 30, 2023 only.



Guru Nanak Khalsa College for Women

Gujarkhan Campus, Model Town,
LUDHIANA-141 002.

Ph. : 0161-2424668, 2772561

Fax : 0161-2424668

Email: gnkcwidth1@rediffmail.com

Web: gnwidth.com

Ref. No. 249-A/F7

Dated 14-09-2023

To conserve resources and keeping in mind the changing weather, use of air conditioners should be discontinued after 30th September, 2023.

Dr. Maneeta Kahlon

Principal

Dr. MANEETA KAHLON
Principal
G.N.Kh. College for Women
Gujarkhan Campus, Model Town,
Ludhiana.

3. Faulty lights were repaired.
4. Students were sensitized to turn off the fans after the class is over.
5. Electrical wires were repaired



6. Faulty equipments were repaired.



7. Service of water filter was carried.



8. New fans were purchased to replace energy consuming fans.



9. Faulty tubelights were replaced.



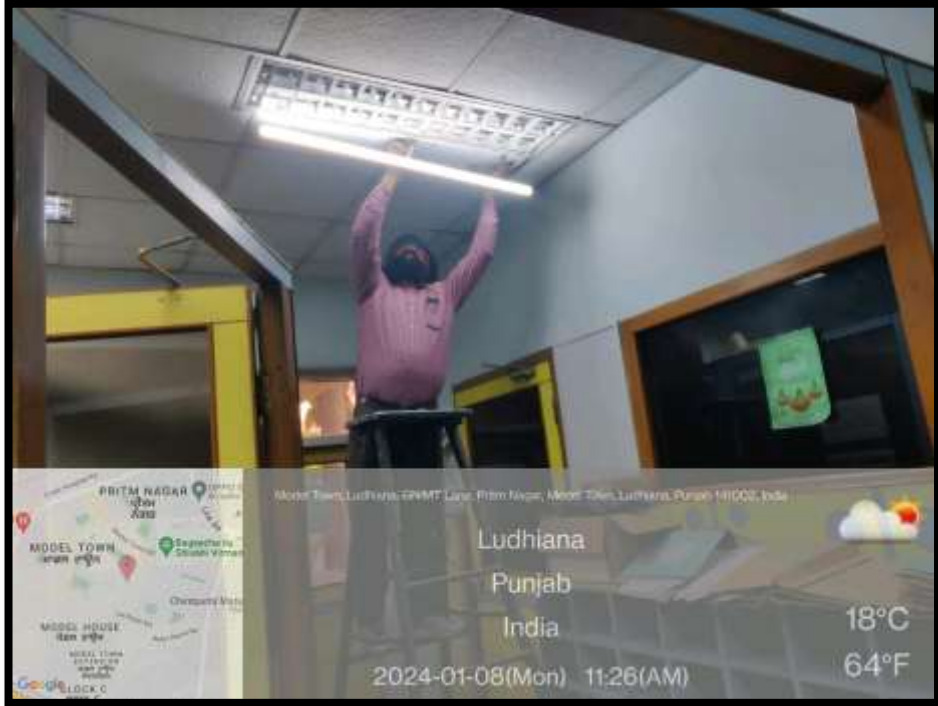

10. AC was installed a heated room.



ACTIVITIES RELATED TO ENERGY CONSERVATION

National Energy conservation day was celebrated on December 14, 2023. During the event, faulty tubelights of college were repaired and replaced wherever required. Apart from this, basic tips on conserving energy were discussed among the students. 20 students participated in the activity.

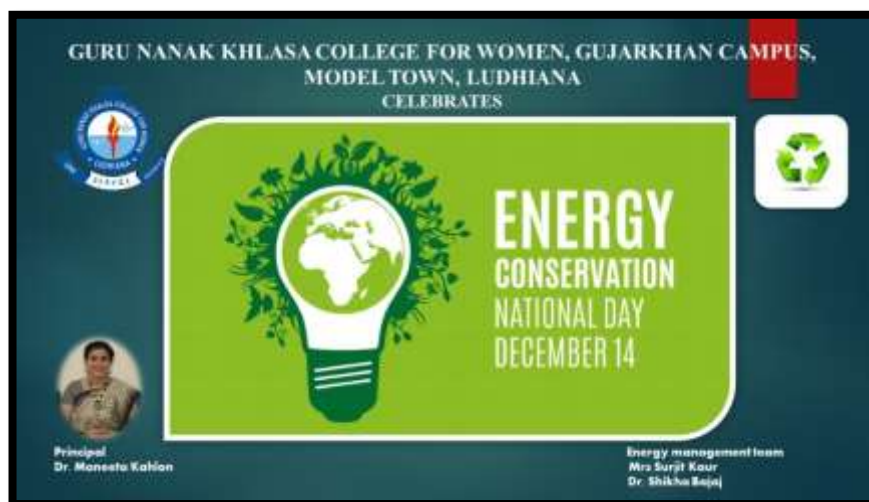



Quality audits on environment and energy are regularly undertaken by the institution. During energy audit, all the electrical items of college were counted and listed down. Apart from this, electricity bills of last 1 year were analysed.

CLASSROOM INFRASTRUCTURE

CLASSROOMS

Room no	Tubelight	Fan
105	3	5
106	2	2
107	3	5
108	3	5
117	2	1
118	4	4
119	6	4
120	4	4
123	2	4
202	7	6
203	3	5
204	1	1
205	3	5
206	6	7
208	5	7
209	8	5
210	7	4
212	1	1
215	7	6
216	6	6
217	5	6
218	1	1
218	2	4
219	2	4
220	2	4
222	2	4
223	3	2
301	3	5
302	3	7
303	3	5
304	4	9
305	4	5
315	4	6
316	4	6
317	4	6
318	1	1
319	2	5
320	2	5
321	2	5
322	2	4
401	4	5
TOTAL	142	186

Maneeta
Dr. MANEETA KAHLON
 Principal
 G.N.Kh. College for Women
 Gujran Khan Campus, Model Town,
 Ludhiana.

LAB INFRASTRUCTURE

Room	Room no	Tubelight	Fan	Wall	Exhaust	Lamp	Table fan
STORE (HSc)	211	1	1				
FOOD LAB	208	7	7				
CLOTHING &	210	4	7				
FASHION DES	209	5	8				
Computer LAB	116	20		2			
Computer LAB	116	8		2			
Computer LAB	116	8		2			
Computer LAB	116	6		2	3		
Fine Arts lab	109	22	12			4	1
Lab	111	3	3				
Lab	121	4	4				
Lab	122	5	4				
Psychology lab	402	4	5				
Mass Com lab	403	4	5				
	TOTAL	101	56	8	3	4	1

Hostel

Room	Room no	Tubelight	Fan	Wall	Exhaust	Geys er	Bulb
New hostel		68	35	1	21	6	
Warden's room		7	5	2	2	1	1
Old hostel		110	93		9	11	3
	TOTAL	185	133	3	32	18	4

STAFF ROOM INFRASTRUCTURE

Room	Room no	Tubelight	Fan	Bulb	Exhaust	Table fan
Main staff room		4	6			
Language staff room		2	2			
Fine Arts staff room		2	1		1	
Vice principal staff room		2	2			
Eng staff room		2	1			
Computer staff room		1	1			
Commerce visiter room		1	1			
Commerce staff room		2	4	5		1
Staff room first floor		1	1			
Home Sci staff room		2	1			
	TOTAL	19	20	5	1	1

Maneeta

Dr. MANEETA KANLON
Principal
G.N.Kh. College for Women
Gujarkhan Campus, Model Town.

Offices and Other Rooms

Room	Room no	Tubelight	Fan	Bulb	haust f	wall fans	able fplk light
Old NCC room	124	2	1				
Medical room	126	2	2	LED 1			
Visiter room	127	2	3	LED 1	1		
Home Sci lab assistant room		1	1				
President sir's meeting room				34	1		
Library	21	30			4	4	
Tuck shops		1	1	4			
Basement parking		13			4		
Upside parking		4	1		1		
Babaji's room		1		11			1
Canteen		8	12	11	2		
Canteen kitchen		3	2	2	3		
Canteen store				2			
Canteen Water area		1					
Principal office		6	1	3		2	
Pantry		2	1				
Administarive office		14		20			
Auditorium		4		87	1	21	2
TV room		2	6				
Sec sir office		2	4	3			
	TOTAL	98	36	177	17	27	1 2

Corridors

Room	Room no	Tubelight	Fan	Bulb	Coolers	haust fan
Ground floor		9	5	9		
First floor		4	2	8		
Second floor		1		10		
Third floor		1				
Home Sci corridor		2			2	
Office Corridor		2	3			
Lawn				6		
Basement		17	12			5
	TOTAL	36	22	33	2	5

Washrooms

Room	Room no	Tubelight	Bulb	haust fan
Home Sci staff room				1
Wasroom near Hsc			1	1
Library washroom			1	
Canteen washroom		1		1
Principal mam's washroom		1		1
Administartive washroom			1	1
Students washrooms			7	
Sec sir room's washroom		1		1
	TOTAL	3	10	6

Dr. MANEETA
 Principal
 G.N.Kh. College for Women
 Gujarkhan Campus, Model Town,
 Ludhiana.

Peons' homes

Room	Room no	Tubelight	Fan	Bulb	Table fan	Cooler
Joginder		1		3	1	1
Amit		2		2		1
Subhash		1	1	2		1
Yadav		1	1	1		
Manish		1	1	1		1
Gardener's home		1	1	1		
Vipin		1	1	1		1
	TOTAL	8	5	11	1	5

Room	Room no	Tubelight	Fan	Table fan
Ground store 1				1
Ground store 2		1		
Ground store 3				
near generator room		1	1	
Auditorium store		1	1	
1st basement (store)				
computer lab (store)				1
W 123 room (store)		1		1
Sports store		2	1	
	TOTAL	6	3	3

GRAND SUMMARY

FANS	TUBELIGHTS	BULBS	TABLE FAN	TABLE FAN	COOLERS	POLY
461	598	240	7	64	18	2

Maneeta

Dr. MANEETA KAHLON
Principal
G.N.Kh. College for Women
Gujarkhan Campus, Model Town,
Ludhiana.

ELECTRICITY BILL ANALYSIS (2023-24):

①

PUNJAB STATE POWER CORPORATION LIMITED (Head Office: P.S.E. Head Office, The Mall, Patna-141001 Ph: 1072) CN: UG1839291850021813 E-mail: 1812@pspc.in Website: www.pstcl.in Q&A NO: 63AAEP51280120 Original for Recipient Duplicate for Supplier. Suitable for 10% Invoice eDP Bill of Supply											Billing Category							
Sub Division: District: Circle: Bill Cycle: Bill Date: Bill Per:											6525AP 40KVA 40 HT BLK SUPPLY DPC							
Sub Division: District: Circle: Bill Cycle: Bill Date: Bill Per:											6525AP 40KVA 40 HT BLK SUPPLY DPC							
AC No: 3862811337 Consumer Name: M.S. PRIN. GIKI COLLEGE (P) Address: OLIAPRANW CAMPUS MTOWN, LUDHIANA-141001-PIN											Load	Contract Demand	Tarif Type	Bill Status	Due Date	Due Date	Due Date	Bill Amount
GST No: Connection Date: 10-08-2011 Mobile No.: 950000435											174-203		55 HT BLK SUPPLY DPC	0	01 May 2023	01 May 2023	Rs. 13893.00	
Feeder Code: Date of New Reading: Date of Old Reading: Bill Period: Meter Serial: Serial Code: Security code/Meter Security Interest											FD0000001620	22-APR-2023	21-MAR-2023	52	0	24666		
Meter Reading																		
Details	Old Reading	New Reading	Current Units	Meter Multiplier	Line CT Ratio	Meter CT Ratio	Overall Multiplier	MMTS Connection	Old Meter Code	Unit Consumed								
KWH	90546.00	91494.00	1.00	10/5	5/5	2.00				11396								
KVAH	86260.00	908737.00	1.00	10/5	5/5	2.00				12174								
MD	21.702	68.460	1.00	10/5	5/5	2.00				138.931								
(A) Fixed Charges																		
Contract Demand (B) KVA	Actual Demand KVA (A)	80% of (B) KVA (B)	A or B whichever greater KVA (C)	Rate per KVA (per month) (D)	Billing Day (E)	A. Fixed Charges Amount = CxDx12/365												
138.931	138.36	138.36	138.36	300.00	32	43595.00												
(B) Energy Charges																		
	Units	Rps/Wh	Amount	B. Total Energy Charges														
0-100	0		0.00	77670														
100-300	0		0.00															
300-500	0		0.00															
500 & ABOVE	0		0.00															
(C) Fuel Cost Adjustment Charges																		
Total Energy Charges	KVAH Consumption	Rate of FCA/KVAH	C Amount	Unit	Rate	Amount	C FCA + Add Surcharges											
77670			0.00			0.00	77670											
(D) Rental Charges																		
Meter Rent for PSPL, Meter	MCB, CT/PT Unit Rental	Rent for any other equipment	Total Rent	HIN Code	SGST	CGST	Total GST	D. Total Rent with Tax										
1264	0		1264		113.76	113.76	227.52	1491.52										
(E) Surcharges																		
Voltage Surcharge			Demand Surcharge			TnD Surcharge												
Supply Voltage	Calmed Voltage	Surcharge Rate	Voltage Surcharge Amount	Demand in excess	Rate of Demand Surcharge	Amount of Demand Surcharge	Peak Hours KVAH	Rate	Amount	E. Total Surcharge (Rs.)								
11.00	11.00		0.00	0.00	0.00	0.00			0.00	0.00								
(F) Rebates																		
Voltage Rebates					TnD Rebates													
Units	HT/EHT Rebate	Amount	Non-Peak Hours KVAH			Rate	Amount	F. Total Rebates (Rs.)										
0.00	0.00	0.00	640.00			1.25	1000.00	1000.00										
(G) Previous Adjustment Amount																		
Units	Fixed Charges	Energy Charges	FCA	Rentals	Surcharge(+)	Rebate(-)	Taxes	Subsidy	Total	G. Net Previous Adjustment (Rs.)								
							0		0	0								
(H) Surcharge/Allowances																		
Late Payment Interest	Units	Fixed Charges	Energy Charges	FCA	Rentals	Surcharge(+)	Rebate(-)	Taxes	Subsidy	Total								
			0	0	0	0	0	0		0								
(I) Subsidy																		
Subsidized KVAH	Rate for Subsidy		Amount							I. Net Subsidy (Rs.)								
12174	0.00		0.00							0.00								

PUNJAB STATE POWER CORPORATION LIMITED											
(Regd. Office P. S. E. Head Office, The Mall Patna-147001, Ph. 2912, CDR 13401089241860033813 E-mail: 1812@pspc.in, Website: www.pspc.in, GSTIN NO: 03AAFC0412901ZC Original for Recipient Duplicate for Supplier, Taxable for use, Invoice from Bill of Supply											
Billing Category					GSC/SAP NONRBM/BS HT BULK SUPPLY DFC						
Sub Division	Date	Circle	Bill Cycle	Bill Date	Bill No.						
SUB DIVISION(T/UNIT-2)	MOHEL, TOWN SPECIAL D	WEST CITY (LUHANA)	02-2024	23-FEB-2024	50024279494						
AVC No: 3002811737	Consumer Name: MS PRIN GRK COLLEGE (W)		Lead	Contract Demand	Tariff Type	Bill Status	Due Date	Bill Amount			
Address: GUJARO-WAN CAMPUS MTOWN LUHANA, 141001-INDIA		174.200		95 HT BLKR (LUFTY DFC)	0	11-Mar-2024	06-Mar-2024	Rs. 182236/-			
GST No:	Connection Date: 10-06-2011	Details of Meter		Meter Number	Make	Capacity	Digi	Meter Status	CT Make	CT No.	
Mobile No.: 9570000455		11.00	12496206	L&T	5-6	0	0	008			
Feeder Code	Date of New Reading	Date of Old Reading	Bill Period	Meter Security	Securt Cons	Security complete		Security Inland			
FDC000001020	22-FEB-2024	22-JAN-2024	31	0	240998						
Meter Reading											
Details	Old Reading	New Reading	Current Units	Meter Multiplier	Line CT Ratio	Meter CT Ratio	Overall Multiplier	MMTS Connection	Old Meter Cons	Unit Consumed	
KVAH	989062.00	995375.00		1.00	10/5	5/5	2.00			12525	
KVAH	1046702.00	1053261.00		1.00	10/5	5/5	2.00			13118	
MDI	14.632	32.477		1.00	10/5	5/5	2.00			64.955	
(A) Fixed Charges											
Contract Demand (L) KVA	Actual Demand KVA (A)	80% of (L) KVA (B)	A or B whichever greater KVA (C)	Rate per KVA per month (R)	Billing Days (D)	A. Fixed Charges Amount		-C/RxDx12/365			
	64.955	139.36	139.36	340.00	31	68160.00					
(B) Energy Charges											
	Units	Rate/Wh	Amount	B. Total Energy Charges							
0-100	0		0.00	88940							
100-300	0		0.00								
300-500	0		0.00								
500 & ABOVE	0		0.00								
(C) Fuel Cost Adjustment Charges											
Total Energy Charges	KVAH Consumption	Rate of FCA/KVAH	C Amount	Unit	Rate	Amount	C. FCA + Addl Surcharges				
88940			0.00			0.00	88940				
(D) Rental Charges											
Meter Rent for PSPCL Meter	MCB, CT/PT Unit Rental	Rent for any other equipment	Total Rent	HSN Code	SGST	CGST	Total GST	D. Total Rent with Tax			
1264	0		1264		113.76	113.76	227.52	1491.52			
(E) Surcharges											
Voltage Surcharge			Demand Surcharge			ToD Surcharge					
Supply Voltage	Colored Voltage	Surcharge Rate	Voltage Surcharge Amount	Demand in excess	Rate of Demand Surcharge	Amount of Demand Surcharge	Peak Hours KVAH	Rate	Amount	E. Total Surcharge (Rs.)	
11.00	11.00		0.00	0.00	0.00	0.00	0.00		0.00	0.00	
(F) Rebates											
Voltage Rebates					ToD Rebates						
Units	HT/EHT Rebate	Amount	Non-Peak Hours KVAH	Rate	Amount	F. Total Rebates (Rs.)					
0.00	0.00	0.00	2236.00	1.00	2236.00	2236.00					
(G) Previous Adjustment Amount											
Units	Fixed Charges	Energy Charges	FCA	Rebates	Surcharge(+)	Rebate(-)	Taxes	Subsidy	Total	G. Net Previous Adjustment (Rs.)	
	/	/	/0	/	/	/0	/0	/0	0/-100	0/-100	
(H) Sundry Charges/Allowances											
Late Payment Interest	Units	Fixed Charges	Energy Charges	FCA	Rebates	Surcharge(+)	Rebate(-)	Taxes	Subsidy	Total	H. Net Sundry Charges/Allowances (Rs.)
	/	/	/0	/0	/0	/	/0	/0	/	/0	/0
(I) Subsidy											
Subsidized KVAH	Rate for Subsidy	Amount	I. Net Subsidy (Rs.)								
13118	0.00	0.00	0.00								



Guru Nanak Khalsa College for Women

Gujarkhan Campus, Model Town,
LUDHIANA-141 002.
Ph. : 0161-2424668, 2772561
Fax : 0161-2424668
Email : gnkcwldh1@rediffmail.com
Web : gnwldh.com

Ref. No.

GNN 23-24

Dated

26/2/24

The Manager
Indian Bank,
Model Town,
Ludhiana.

Dated 26.02.2024

Subject:- Payment of Electricity bill PSPCL for the period 22 Jan,24 to 22 Feb,24.

Sir,

Kindly debit a sum of Rs. 163230- (Rs. One Lac, sixty three thousand, two hundred and thirty only) to our SB A/c no. 463430129 and transfer this amount through RTGS to Punjab State Power Corporation Limited PSPCLA3002811737MP IFSC code SBIN 0004266 SBI, CMP, Central Mumbai.

Consumer detail

Electricity A/c No. 3002811737

Principal, G.N.Khalsa College for Women,
95010-17435(M)

Email: Id- gnkcwldh1@rediffmail.com

Sub division code 2453

Division code - 245.

Yours Sincerely,

Dr. Maneta Kahlon
Principal
G.N. Kh. College for Women,
Model Town, LUDHIANA

26/2/24

1018H
24057455679

2/28/24, 9:17 AM

Receipt@mail

12

Subject: Bill Payment Receipt For Account 3002811737

PSPCL DoNotReply <onlinebill@pspcd.in>

Sent: Tue, 27 Feb 2024 23:36:35 GMT+0530

To: You



Punjab State Power Corporation Ltd.

Bill Payment Successful !
Below are the payment details.

Consumer Name	M/S
Account No.	3002811737
Bill Due Date	
Transaction Date	26 FEB, 2024
Receipt No.	203260251
Gateway Ref. No.	SBI2402260000268
Bill Category	BS HT BULK SUPPLY DPC
Bill Cycle/Group	0/0
Sub Division Name	
Amount Paid	Rs.163230/-
Amount in Words	One Lakh Sixty Three Thousand Two Hundred Thirty Rupees Only
Payment Status	Amount Realized.

"Keeping it simple for the consumer is incredibly dire."
Thanks for the payment

Best Regards,
PSPCL IT Team,
Customer Care Number: 1912
Customer Care E-mail: 1912@pspcd.in
Customer Care E-mail: helpdesk-pspcd@pspcd.in

LOGIN TO VIEW RECEIPT FOR 3002811737

(J) Taxation								
Electricity Duty	Municipal Tax	IDF	Cow Cess	Total Tax	Net Energy Charges	TCS/TDS	Cur/Prev Rounding Amount	NET BILL AMOUNT Rs. 137610/-
14756.00	2270.00	5676.00	0.00	22704		0.00		One Lakh Thirty Seven Thousand Six Hundred Ten Rupees Only

(K) Total Billed Amount				
Due Date by Cash/Online	Due Date by DD/Cheque	Net Amount Payable by due date	Simple interest on delayed payment @1.5%p.m.	Amount Payable within 1 month after due date
07-Feb-2024	05-Feb-2024	137610	2064	139674

(L) Previous Cycle's Consumption												
MONTH	FEB-23	MAR-23	APR-23	MAY-23	JUN-23	JUL-23	AUG-23	SEP-23	OCT-23	NOV-23	DEC-23	JAN-24
MDI.51	43	138	138	80	80	59	174	110	149	113	67	29
KWH11362	-	11096	21956	7576	11722	29428	36240	14226	8370	9238	9178	9178
KVAH12222	10528	12174	22866	8092	12276	30018	39112	15066	9054	9752	9692	9692

Payment History:
Last Payment Amount:Rs 132610, Dated: 27-12-2023

Message:

1. Payments exceeding Rs.20,000/- shall be accepted in digital mode only w.e.f. 01-07-2021.
2. In case the payment of billed amount is not made by the due date, the power supply shall be liable for disconnection after expiry of 15 days of the due date and this may be taken as notice under section 56 of the Electricity Act 2003 read with regulation 32 of the Supply Code, 2014.
3. CHARGES HAS BEEN CHARGED AS ED @ 13% OF SOP, MT @ 2% OF SOP, IDF @ 5% OF SOP, CONCESS @ 1 OR 2 PAISA PER KWH/KVAH
4. ADJUSTMENT DETAIL WITH PERIOD:
5. - UNPAID DUES - A) LATE PAYMENT SURCHARGES : 0 B) LATE PAYMENT INTEREST : 0
6. LATE PAYMENT INTEREST @1.5% PER MONTH ON GROSS UNPAID AMOUNT OF THE BILL TILL DEPOSIT OF OUTSTANDING AMOUNT AFTER DUE DATE SHALL BE CHARGED

Description (HSN Code)	Quantity	UOC	Non-Taxable Amount	Taxable Amount	CGST 9%	SGST 9%	Total
Meter Rent (997319)	1	-	0	1264	113.76	113.76	1491.52
MCB Rent (997319)	1	-	0	0	0	0	0
Electrical Energy (271600)	9178	UNT-Units	0	0	0	0	0

Powered by O/o CE(ET) PSPCL

Print Date: 01-23-2024 11:00 PM

PUNJAB STATE POWER CORPORATION LIMITED (Regd. Office P.S.E.B. Head Office, The Mall Patiala-147001 Ph. 1912) CIN: U40109PB2010BGC033813 E-mail: 1912@pspcd.in, Website: www.pspd.in, GSTIN NO: 03AAFCPS126Q1ZC Original for Recipient Duplicate for Supplier, Taxable Invoice, Invoice-cum-Bill of Supply										Billing Category GGC/SAP-NONSH-95 HT BULK SUPPLY DPC													
Sub Division		Division		Circle		Bill Cycle		Bill Date		Bill No.													
SUB DIVISION(T)/UNIT-2		MODEL TOWN SPECIAL D		WEST CITY LUDHANA		01-2024		23-JAN-2024		50023947263													
A/C No.: 3002811737 Consumer Name: M/S PREN GNK COLLEGE (M) Address: GURJARAN CAMPUS MTOWN LUDHANA-141001-INDIA GST No.: Connection Date: 10-08-2011 Mobile No.: 9800000435				Load		Contract Demand		Tariff Type		Bill Status		Due Date		Bill Amount									
				174.200				BS HT BULK SUPPLY DPC		O		07-Feb-2024		05-Feb-2024		Rs.137819/-							
				Voltage Supply		Details of Meter				Meter Status		CT Make		CT No.									
11.00		12466206		L&T		5-6		8		O		658											
Feeder Code		Date of New Reading		Date of Old Reading		Bill Period		Meter Security		Security Cons		Security cons/Meter Security Interest											
FD0000001620		22-JAN-2024		21-DEC-2023		32		0		248696													
Meter Reading																							
Details		Old Reading		New Reading		Current Units		Meter Multiplier		Line CT Ratio		Meter CT Ratio		Overall Multiplier		MMTS Connection		Old Meter Cons.		Unit Consumed			
KWH		984473.00		989062.00		1.00		105		5/5		2.00								9178			
KVAH		1041836.00		1046702.00		1.00		105		5/5		2.00								9992			
MCD		33.824		14.632		1.00		105		5/5		2.00								29.265			
(A) Fixed Charges																							
Contract Demand (L) KVA		Actual Demand KVA (A)		80% of (L) KVA (B)		A or B whichever greater KVA (C)		Rate per KVA per month (R)		Billing Days (D)		A: Fixed Charges Amount +CoRcDt12/365											
		29.265		139.36		139.36		340.00		32		49714.00											
(B) Energy Charges																							
		Units		Rate/W/h		Amount		B: Total Energy Charges															
0-100		0				0.00		65712															
100-300		0				0.00																	
300-500		0				0.00																	
500 & ABOVE		0				0.00																	
(C) Fuel Cost Adjustment Charges																							
Total Energy Charges		KVAH Consumption		Rate of FCS/KVAH		C Amount		Unit		Rate		Amount		C FCA + Adst Surcharges									
65712						0.00						0.00		65712									
(D) Rental Charges																							
Meter Rent for PSPCL Meter		MOB, CT/PT Unit Rental		Rent for any other equipment		Total Rent		HEN Code		SGST		CGST		Total GST		D Total Rent with Tax							
1264		0				1264				113.76		113.76		227.52		1491.52							
(E) Surcharges																							
Voltage Surcharge				Demand Surcharge				ToD Surcharge															
Supply Voltage		Catered Voltage		Surcharge Rate		Voltage Surcharge Amount		Demand in excess		Rate of Demand Surcharge		Amount of Demand Surcharge		Peak Hours KVAH		Rate		Amount		E: Total Surcharge (Rs.)			
11.00		11.00						0.00		0.00		0.00		0.00				0.00		0.00			
(F) Rebates																							
Voltage Rebates						ToD Rebates																	
Units		HT/EHT Rebate		Amount		Non-Peak Hours KVAH		Rate		Amount		F: Total Rebates (Rs.)											
0.00		0.00		0.00		1904.00		1.00		1904.00		1904.00											
(G) Previous Adjustment Amount																							
Units		Fixed Charges		Energy Charges		FCA		Rentals		Surcharges(+)		Rebates(-)		Taxes		Subsidy		Total		G: Net Previous Adjustment (Rs.)			
		/		/		/		/		/		/		0		0-100		0-100					
(H) Sundry Charges/Allowances																							
Late Payment Interest		Units		Fixed Charges		Energy Charges		FCA		Rentals		Surcharges(+)		Rebates(-)		Taxes		Subsidy		Total		H: Net Sundry Charges/Allowances (Rs.)	
/		/		/0		/0		/0		/0		/0		/0		/0		/0		/0		/0	
(I) Subsidy																							
Subsidized KVAH		Rate for Subsidy		Amount		I: Net Subsidy (Rs.)																	
6692		0.00		0.00		0.00																	

1/27/24, 9:21 AM

Rediffmail



Subject: Bill Payment Receipt For Account 3002811737

PSPCL DoNotReply <onlinebill@pspcl.in>

Sent: Fri, 26 Jan 2024 20:15:06 GMT+0530

To: You



Punjab State Power Corporation Ltd.

Bill Payment Successful !
Below are the payment details.

Consumer Name	M/S
Account No.	3002811737
Bill Due Date	
Transaction Date	24 JAN, 2024
Receipt No.	202339440
Gateway Ref. No.	SBI2401240000207
Bill Category	BS HT BULK SUPPLY DPC
Bill Cycle/Group	0/0
Sub Division Name	
Amount Paid	Rs.137610/-
Amount in Words	One Lakh Thirty Seven Thousand Six Hundred Ten Rupees Only
Payment Status	Amount Realized.

"Anyone who has never made a mistake has never tried anything new."
Thanks for the payment

Best Regards,
PSPCL IT Team,
Customer Care Number: 1912
Customer Care E-mail: 1912@pspcl.in
Customer Care E-mail: helpdesk-pspcl@pspcl.in

LOGIN TO VIEW RECEIPT FOR 3002811737



Punjab State Power Corporation Ltd.

Bill Payment Successful !
Below are the payment details.

Consumer Name	M/S
Account No.	3002811737
Bill Due Date	
Transaction Date	26 DEC, 2023
Receipt No.	201509462
Gateway Ref. No.	SBI2312260000049
Bill Category	BS HT BULK SUPPLY DPC
Bill Cycle/Group	0/0
Sub Division Name	
Amount Paid	Rs.132610/-
Amount in Words	One Lakh Thirty Two Thousand Six Hundred Ten Rupees Only
Payment Status	Amount Realized.

"The only knowledge that can hurt you is the knowledge you don't have."
Thanks for the payment

Best Regards,
PSPCL IT Team,
Customer Care Number: 1912
Customer Care E-mail: 1912@pspcl.in
Customer Care E-mail: helpdesk-pspcl@pspcl.in

LOGIN TO VIEW RECEIPT FOR 3002811737

(J) Taxation					Net Energy Charges	TCS/STDS	ConPrev Rounding Amount	NET BILL AMOUNT
Electricity Duty	Municipal Tax	IDF	Cow Cess	Total Tax				Rs.122610/-
14204.00	2185.00	5463.00	0.00	21852		0.00		One Lakh Thirty Two Thousand Six Hundred Ten Rupees Only

(K) Total Billed Amount

Due Date by Cash/Online	Due Date by DD/Cheque	Net Amount Payable by due date	Single interest on delayed payment @1.5% p.m.	Amount Payable within 1 month after due date
05-Jan-2024	04-Jan-2024	132610	1969	134579

(L) Previous Cycle's Consumption

MONTH	DEC-22	JAN-23	FEB-23	MAR-23	APR-23	MAY-23	JUN-23	JUL-23	AUG-23	SEP-23	OCT-23	NOV-23
MDI-32	38	51	43	138	80	80	80	59	174	110	149	113
KWH@9146	-	11362	9720	11096	21966	7576	11722	29426	38240	14228	14228	8370
KVAH 10054	9430	12222	10528	12174	22866	8092	12276	30018	39112	15068	15068	9054

Payment History:

Last Payment Amount:Rs. 57170. Dated: 29-11-2023

Message:

1. Payments exceeding Rs.25,000/- shall be accepted in digital mode only w.e.f. 01-07-2021.
2. In case the payment of billed amount is not made by the due date,the power supply shall be liable for disconnection after expiry of 15 days of the due date and this may be taken as notice under section 56 of the Electricity Act 2003 read with regulation 32 of the Supply Code, 2014.
3. CHARGES HAS BEEN CHARGED AS ED @ 13% OF SOP, MT @ 2% OF SOP, IDF @ 0% OF SOP, CONCESSION @ 1 OR 2 PAISA PER KWH/KVAH.
4. ADJUSTMENT DETAIL WITH PERIOD:
5. - UNPAID DUES - A) LATE PAYMENT SURCHARGES : 0 B) LATE PAYMENT INTEREST : 0
6. LATE PAYMENT INTEREST @ 5% PER MONTH ON GROSS UNPAID AMOUNT OF THE BILL TILL DEPOSIT OF OUTSTANDING AMOUNT AFTER DUE DATE SHALL BE CHARGED.

Description (HSN Code)	Quantity	UDC	Non-Taxable Amount	Taxable Amount	CGST 9%	SGST 9%	Total
Meter Rent (997319)	1	-	0	1264	113.76	113.76	1491.52
MCB Rent (997319)	1	-	0	0	0	0	0
Electrical Energy (271600)	9238	UNT-Units	0	0	0	0	0

Powered by Ojo CE(T) PMSCL

Print Date: 12-22-2023 11:03 PM

PUNJAB STATE POWER CORPORATION LIMITED										Billing Category	
(Regd. Office P.S.E.B. Head Office, The Mall Patiala-147001, Ph. 1912), CIN: U40109PB0019800033813 E-mail: 1912@pspcpl.in, Website: www.pspcl.in, GSTIN NO: 03AAFCPS120Q1ZC Original for Recipient Duplicate for Supplier, Taxable Invoice, Invoice-cum-Bill of Supply										GSGTAP-NONBEM-BS HT BULK SUPPLY DPC	
Sub Division	Division	Circle	Bill Cycle	Bill Date	Bill No.						
SUB DIVISION(T)/UNIT-2	MODEL TOWN SPECIAL D	WEST CITY LUDHIANA	12-2023	22-DEC-2023	51413736455						
A/C No.: 3002811737 Consumer Name: M/S PRIN. GNK COLLEGE (W) Address: GUJARKHAN CAMPUS MTOWN,LUDHIANA-141001-INDIA GST No.: Connection Date: 10-08-2011 Mobile No.: 950000435			Load	Contract Demand	Tariff Type	Bill Status	Due Date	Bill Amount			
			174.203		BS-HT BULK SUPPLY DPC	0	08-Jan-2024	04-Jan-2024	Rs. 1324.00		
			Details of Meter				Meter Status	CT Make	CT No.		
			Voltage Supply	Meter Number	Make	Capacity	Digit	0	858		
			11.00	12466206	L&T	5-6	8				
Feeder Code	Date of New Reading	Date of Old Reading	Bill Period	Meter Security	Security Cons.	Security cons/Meter Security Interest					
FDD0000001620	21-DEC-2023	22-NOV-2023	29	0	246665						
Meter Reading											
Details	Old Reading	New Reading	Current Units	Meter Multiplier	Line CT Ratio	Meter CT Ratio	Overall Multiplier	MCTS Correction	Old Meter Cons.	Unit Consumed	
KWH	979854.00	984473.00		1.00	10/5	5/5	2.00			9238	
KVAH	1036980.00	1041856.00		1.00	10/5	5/5	2.00			9752	
MCI	56.518	33.824		1.00	10/5	5/5	2.00			67.649	
(A) Fixed Charges											
Contract Demand (L) KVA	Actual Demand KVA (A)	80% of (L) KVA (B)	A or B whichever greater KVA (C)	Rate per KVA per month (R)	Billing Days (D)	A: Fixed Charges Amount =CRDr12/365					
	67.649	139.36	139.36	340.00	29	45175.00					
(B) Energy Charges											
	Units	Rate/Wh	Amount	B: Total Energy Charges							
0-100	0		0.00	66119							
100-300	0		0.00								
300-500	0		0.00								
500 & ABOVE	0		0.00								
(C) Fuel Cost Adjustment Charges											
Total Energy Charges	KVAH Consumption	Rate of FCS/KVAH	C: Amount	Unit	Rate	Amount	C: FCA + Addl. Surcharges				
66119			0.00			0.00	66119				
(D) Rental Charges											
Meter Rent for PSPCL Meter	MCB, CT/PT Unit Rental	Rent for any other equipment	Total Rent	HSN Code	SGST	CGST	Total GST	D: Total Rent with Tax			
1264	0		1264		113.76	113.76	227.52	1491.52			
(E) Surcharges											
Voltage Surcharge			Demand Surcharge			ToD Surcharge					
Supply Voltage	Catered Voltage	Surcharge Rate	Voltage Surcharge Amount	Demand in excess	Rate of Demand Surcharge	Amount of Demand Surcharge	Peak Hours KVAH	Rate	Amount	E: Total Surcharge (Rs.)	
11.00	11.00			0.00	0.00	0.00	0.00		0.00	0.00	
(F) Rebates											
Voltage Rebates					ToD Rebates						
Units	HT/EHT Rebate	Amount	Non-Peak Hours KVAH	Rate	Amount	F: Total Rebates (Rs.)					
0.00	0.00	0.00	2036.00	1.00	2036.00	2036.00					
(G) Previous Adjustment Amount Notice No. and Date:											
Units	Fixed Charges	Energy Charges	FCA	Rentals	Surcharge(+)	Rebate(-)	Taxes	Subsidy	Total	G: Net Previous Adjustment (Rs.)	
	/	/	/	/	/	/	0		0	0	
(H) Sundry Charges/Allowances Notice No. and Date:											
Late Payment Interest	Units	Fixed Charges	Energy Charges	FCA	Rentals	Surcharge(+)	Rebate(-)	Taxes	Subsidy	Total	H: Net Sundry Charges/Allowances (Rs.)
	/	/	0	0	0	/	0	0	/	0	0
(I) Subsidy											
Subsidized KVAH	Rate for Subsidy	Amount	I: Net Subsidy (Rs.)								
9752	0.00	0.00	0.00								

Rediffmail

Subject: Bill Payment Receipt For Account 3002811737

PSPCL DoNotReply <onlinebill@pspcl.in>
Sent: Wed, 29 Nov 2023 11:42:02 GMT+0530
To: You



Punjab State Power Corporation Ltd.

Bill Payment Successful !
Below are the payment details.

Consumer Name	M/S
Account No.	3002811737
Bill Due Date	
Transaction Date	28 NOV, 2023
Receipt No.	200643577
Gateway Ref. No.	SBI2311280001289
Bill Category	BS HT BULK SUPPLY DPC
Bill Cycle/Group	0/0
Sub Division Name	
Amount Paid	Rs.57170/-
Amount in Words	Fifty Seven Thousand One Hundred Seventy Rupees Only
Payment Status	Amount Realized.

"The most important thing in communication is hearing what isn't said."
Thanks for the payment

Best Regards,
PSPCL IT Team.
Customer Care Number: 1912
Customer Care E-mail: 1912@pspcl.in
Customer Care E-mail: helpdesk-pspcl@pspcl.in

LOGIN TO VIEW RECEIPT FOR 3002811737

(J) Taxation								NET BILL AMOUNT
Electricity Duty	Municipal Tax	IDF	Cow Cess	Total Tax	Net Energy Charges	TCS/TDS	CumFrev Rounding Amount	Rs. 57170/-
14180.00	2182.00	5454.00	0.00	21816		0.00		Fifty Seven Thousand One Hundred Seventy Rupees Only

(K) Total Billed Amount				
Due Date by Cash/Online	Due Date by DD/Cheque	Net Amount Payable by due date	Simple interest on delayed payment @1.5%p.m.	Amount Payable within 1 month after due date
05-Dec-2023	06-Dec-2023	57170	858	58028

(L) Previous Cycle's Consumption											
MONTH NOV-22	DEC-22	JAN-23	FEB-23	MAR-23	APR-23	MAY-23	JUN-23	JUL-23	AUG-23	SEP-23	OCT-23
MDI-46	32	38	51	43	138	80	80	59	174	110	149
KWH-9946	-	8712	11362	9720	11096	21956	7576	11722	29428	38240	14228
KVAH-11004	10054	9430	12222	10528	12174	22866	6092	12276	30018	39112	15068

Payment History:
Last Payment Amount:Rs 238220, Dated: 03-11-2023

Message:

1. Payments exceeding Rs.20,000/- shall be accepted in digital mode only w.e.f. 01-07-2021.
2. In case the payment of billed amount is not made by the due date, the power supply shall be liable for disconnection after expiry of 15 days of the due date and this may be taken as notice under section 56 of the Electricity Act 2003 read with regulation 32 of the Supply Code, 2014.
3. CHARGES HAS BEEN CHARGED AS ED @ 13% OF SOP, MT @ 2% OF SOP, IDF @ 5% OF SOP, CONCESS @ 1 OR 2 PAISA PER KWH/KVAH
4. ADJUSTMENT DETAIL WITH PERIOD.
5. - UNPAID DUES :- A) LATE PAYMENT SURCHARGES : 0 B) LATE PAYMENT INTEREST : 0
6. LATE PAYMENT INTEREST @1.5% PER MONTH ON GROSS UNPAID AMOUNT OF THE BILL TILL DEPOSIT OF OUTSTANDING AMOUNT AFTER DUE DATE SHALL BE CHARGED.

Description (HSN Code)	Quantity	UQC	Non-Taxable Amount	Taxable Amount	CGST 9%	SGST 9%	Total
Meter Rent (997319)	1	-	0	1264	113.76	113.76	1491.52
MCB Rent (997319)	1	-	0	0	0	0	0
Electrical Energy (271600)	8370	UNT-Units	0	0	0	0	0

Powered by Ojo CE(T) PSPCL

Print Date: 11-25-2023 08:26 AM

PUNJAB STATE POWER CORPORATION LIMITED (Regd. Office P.S.E.B. Head Office, The Mall Patiala-147001 Ph. 1012) CIN: LHO1000PBO10000033413 E-mail: 1012@pspc.in, Website: www.pspcl.in, GSTIN: IND 05AACP051200120 Original for Recipient Duplicate for Supplier, Taxable Invoice, Invoice-com-Bill of Supply										Billing Category	
Sub-Division										Billing Category	
Sub-Division(T)/UNIT-2										Billing Category	
A/C No. 3002811737 Consumer Name: 145 PNB INK COLLEGE (M) Address: QLUARHWAN CAMPUS MITOWN LUDHIANA-141001 INDIA										Billing Category	
GST No.:										Billing Category	
Connection Date: 10-08-2011										Billing Category	
Mobile No. 9500000435										Billing Category	
Feeder Code										Billing Category	
Date of New Reading										Billing Category	
Date of Old Reading										Billing Category	
Bill Period										Billing Category	
Meter Security										Billing Category	
Security Code/Meter Security Interest										Billing Category	
Meter Reading										Billing Category	
Details										Billing Category	
Old Reading										Billing Category	
New Reading										Billing Category	
Current Units										Billing Category	
Meter Multiplier										Billing Category	
Line CT Ratio										Billing Category	
Meter CT Ratio										Billing Category	
Overall Multiplier										Billing Category	
MMTS Connection										Billing Category	
Old Meter Const.										Billing Category	
Unit Consumed										Billing Category	
KVAH										Billing Category	
KVAH										Billing Category	
MCH										Billing Category	
(A) Fixed Charges										Billing Category	
Contract Demand (L) KVA										Billing Category	
Actual Demand KVA (A)										Billing Category	
80% of (L) KVA (B)										Billing Category	
A or B whichever greater KVA (C)										Billing Category	
Rate per KVA per month (₹)										Billing Category	
Billing Days (D)										Billing Category	
A: Fixed Charges Amount = CxPxDr/12365										Billing Category	
(B) Energy Charges										Billing Category	
Units										Billing Category	
Rate/Wh										Billing Category	
Amount										Billing Category	
B: Total Energy Charges										Billing Category	
0-100										Billing Category	
100-300										Billing Category	
300-500										Billing Category	
500 & ABOVE										Billing Category	
(C) Fuel Cost Adjustment Charges										Billing Category	
*Additional Surcharges										Billing Category	
Total Energy Charges										Billing Category	
KVAH Consumption										Billing Category	
Rate of FCS/KVAH										Billing Category	
C: Amount										Billing Category	
Unit										Billing Category	
Rate										Billing Category	
Amount										Billing Category	
C: FCA + Add Surcharges										Billing Category	
(D) Rental Charges										Billing Category	
GST										Billing Category	
Meter Rent for PSPCL Meter										Billing Category	
MCH, CT/PT Unit Rental										Billing Category	
Rent for any other equipment										Billing Category	
Total Rent										Billing Category	
HKN Code										Billing Category	
SGST										Billing Category	
CGST										Billing Category	
Total GST										Billing Category	
D: Total Rent with Tax										Billing Category	
(E) Surcharges										Billing Category	
Voltage Surcharge										Billing Category	
Demand Surcharge										Billing Category	
ToD Surcharge										Billing Category	
Supply Voltage										Billing Category	
Catered Voltage										Billing Category	
Surcharge Rate										Billing Category	
Voltage Surcharge Amount										Billing Category	
Demand in excess										Billing Category	
Rate of Demand Surcharge										Billing Category	
Amount of Demand Surcharge										Billing Category	
Peak Hours KVAH										Billing Category	
Rate										Billing Category	
Amount										Billing Category	
E: Total Surcharge (₹.)										Billing Category	
(F) Rebates										Billing Category	
Voltage Rebates										Billing Category	
ToD Rebates										Billing Category	
Units										Billing Category	
HT/LHT Rebate										Billing Category	
Amount										Billing Category	
Non-Peak Hours KVAH										Billing Category	
Rate										Billing Category	
Amount										Billing Category	
F: Total Rebates (₹.)										Billing Category	
(G) Previous Adjustment Amount										Billing Category	
Notice No. and Date:										Billing Category	
Units										Billing Category	
Fixed Charges										Billing Category	
Energy Charges										Billing Category	
FCA										Billing Category	
Rentals										Billing Category	
Surcharges(+)										Billing Category	
Rebates(-)										Billing Category	
Taxes										Billing Category	
Subsidy										Billing Category	
Total										Billing Category	
G: Net Previous Adjustment (₹.)										Billing Category	
(H) Sundry Charges/Allowances										Billing Category	
Notice No. and Date:										Billing Category	
Late Payment Interest										Billing Category	
Units										Billing Category	
Fixed Charges										Billing Category	
Energy Charges										Billing Category	
FCA										Billing Category	
Rentals										Billing Category	
Surcharges(+)										Billing Category	
Rebates(-)										Billing Category	
Taxes										Billing Category	
Subsidy										Billing Category	
Total										Billing Category	
H: Net Sundry Charges/Allowances (₹.)										Billing Category	
(I) Subsidy										Billing Category	
Subsidized KVAH										Billing Category	
Rate for Subsidy										Billing Category	
Amount										Billing Category	
I: Net Subsidy (₹.)										Billing Category	
9054										Billing Category	
0.00										Billing Category	
0.00										Billing Category	
0.00										Billing Category	

12/7/23, 2:35 PM

Bill Payment Receipt For Account 3002811737

8

Subject: Bill Payment Receipt For Account 3002811737

PSPCL DoNotReply <onlinebill@pspc.in>

Sent: Fri, 3 Nov 2023 15:30:45 GMT+0530

To: You



Punjab State Power Corporation Ltd.

Bill Payment Successful !
Below are the payment details.

Consumer Name	M/S
Account No.	3002811737
Bill Due Date	
Transaction Date	02 NOV, 2023
Receipt No.	199877229
Gateway Ref. No.	SBI2311020000142
Bill Category	BS HT BULK SUPPLY DPC
Bill Cycle/Group	0/0
Sub Division Name	
Amount Paid	Rs.238220/-
Amount in Words	Two Lakh Thirty Eight Thousand Two Hundred Twenty Rupees Only
Payment Status	Amount Realized.

"Customer service is an opportunity to exceed your customer's expectations."
Thanks for the payment!

Best Regards,
PSPCL IT Team,
Customer Care Number: 1912
Customer Care E-mail: 1912@pspc.in
Customer Care E-mail: helpdesk-pspc@pspc.in

LOGIN TO VIEW RECEIPT FOR 3002811737

2:34 PM

Bill Payment Receipt For Account 3002811737

Subject: Bill Payment Receipt For Account 3002811737

PSPCL DoNotReply <onlinebill@pspcl.in>

Sent: Thu, 26 Oct 2023 08:16:22 GMT+0530

To: You



Punjab State Power Corporation Ltd.

Bill Payment Successful !
Below are the payment details.

Consumer Name	M/S
Account No.	3002811737
Bill Due Date	
Transaction Date	25 OCT, 2023
Receipt No.	199582841
Gateway Ref. No.	SBI2310250000573
Bill Category	BS HT BULK SUPPLY DPC
Bill Cycle/Group	0/0
Sub Division Name	
Amount Paid	Rs.75020/-
Amount in Words	Seventy Five Thousand Twenty Rupees Only
Payment Status	Amount Realized.

"Kind words can be short and easy to speak, but their echoes are truly endless."
Thanks for the payment

Best Regards,
PSPCL IT Team.
Customer Care Number: 1912
Customer Care E-mail: 1912@pspcl.in
Customer Care E-mail: helpdesk-pspcl@pspcl.in

LOGIN TO VIEW RECEIPT FOR 3002811737

7

PUNJAB STATE POWER CORPORATION LIMITED (Regd. Office P.S.E.B. Head Office, The Mall Patiala-147001 Ph: 1912) CN: 045105P825188G033813 E-mail: 1912@pspc.in, Website: www.pspcl.in, GSTIN NO: 03AAAF05128G1UC Original for Receipt Duplicate for Supplier, Taxable Invoice, Invoice cum Bill of Supply										Billing Category	
Sub-Division		Division	Circle	Bill Cycle	Bill Date	Bill No.	GSC/SAP-NON-SSM-BS HT BULK SUPPLY CPC				
SUB DIVISION(T/UNIT-2)		MODEL TOWN(SPECIAL D)	NEST CITY LUDHIANA	09-2023	23-09-2023	99219642133					
A/C No: 3602811737 Consumer Name: M/S PRIN. CNK COLLEGE (W) Address: GUJARAHAN CAMPUS MITOWN LUDHIANA 141001-INDIA			Load	Contract Demand	Tariff Type	BSR Status	Due Date	Bill Amount			
GST No: Connection Date: 10-08-2011 Mobile No: 9800000435			174.203		BS HT BULK SUPPLY CPC	0	07-Nov-2023	634899	Rs. 79880/-		
			Voltage Supply	Details of Meter			Meter Status	CT Meter	CT No.		
Feeder Code			Date of New Reading	Date of Old Reading	Bill Period	Meter Security	Security Code	Security amt/Meter Security Interest			
F000000001620			30-SEP-2023	22-SEP-2023	8	0	246656				
Meter Reading											
Details	Old Reading	New Reading	Current Units	Meter Multiplier	Line CT Ratio	Meter CT Ratio	Overall Multiplier	AMTS Correction	Old Meter Cons.	Unit Consumed	
KWH	965039.00	968555.00		1.00	10/5	5/5	2.00			7032	
KVAH	1021329.00	1024919.00		1.00	10/5	5/5	2.00			7186	
MCI	87.497	55.195		1.00	10/5	5/5	2.00			110.392	
(A) Fixed Charges											
Contract Demand (L) KVA	Actual Demand KVA (A)	80% of (L) KVA (B)	A or B whichever greater KVA (C)	Rate per KVA per month (R)	Billing Days (D)	A Fixed Charges Amount = CxRxD/12/365					
	110.392	139.36	139.36	340.00	8	12462.00					
(B) Energy Charges											
	Units	Rate/Wh	Amount	B Total Energy Charges							
0-100	0		0.00	48680							
100-300	0		0.00								
300-500	0		0.00								
500 & ABOVE	0		0.00								
(C) Fuel Cost Adjustment Charges											
Total Energy Charges	KVAH Consumption	Rate of PCS/KVAH	C Amount	Unit	Rate	Amount	C FCA + Adst Surcharges				
48680			0.00			0.00	48680				
(D) Rental Charges											
Meter Rent for PSPCL Meter	MCB, CT/PT Unit Rental	Rent for any other equipment	Total Rent	HSN Code	SGST	CGST	Total GST	D Total Rent with Tax			
337	0		337		30.33	30.33	60.66	397.66			
(E) Surcharges											
Voltage Surcharge			Demand Surcharge			ToD Surcharge					
Supply Voltage	Catered Voltage	Surcharge Rate	Voltage Surcharge Amount	Demand in excess	Rate of Demand Surcharge	Amount of Demand Surcharge	Peak Hours KVAH	Rate	Amount	E Total Surcharge (Rs.)	
11.00	11.00			0.00	0.00	0.00	560.00	2.00	1120.00	1120.00	
(F) Rebates											
Voltage Rebates			ToD Rebates								
Units	HT/DHT Rebate	Amount	Non-Peak Hours KVAH	Rate	Amount	F Total Rebates (Rs.)					
0.00	0.00	0.00	0.00		0.00	0.00					
(G) Previous Adjustment Amount											
Units	Fixed Charges	Energy Charges	FCA	Rentals	Surcharge(+)	Rebate(-)	Taxes	Subsidy	Total	G Net Previous Adjustment (Rs.)	
	/	/	/	/	/	/	0		0-100	0-100	
(H) Sundry Charges/Allowances											
Late Payment Interest	Units	Fixed Charges	Energy Charges	FCA	Rentals	Surcharge(+)	Rebate(-)	Taxes	Subsidy	Total	H Net Sundry Charges/Allowances (Rs.)
	/	/	/	/	/	/	/	/	/	/	/
(I) Subsidy											
Subsidised KVAH	Rate for Subsidy		Amount			I Net Subsidy (Rs.)					
7180	0.00		0.00			0.00					



Punjab State Power Corporation Ltd.

Bill Payment Successful !
Below are the payment details.

Consumer Name	M/S
Account No.	3002811737
Bill Due Date	
Transaction Date	28 SEP, 2023
Receipt No.	198480848
Gateway Ref. No.	SBI2309280001252
Bill Category	BS HT BULK SUPPLY DPC
Bill Cycle/Group	0/0
Sub Division Name	
Amount Paid	Rs.339860/-
Amount in Words	Three Lakh Thirty Nine Thousand Eight Hundred Sixty Rupees Only
Payment Status	Amount Realized.

"The only knowledge that can hurt you is the knowledge you don't have."
Thanks for the payment

Best Regards,
PSPCL IT Team,
Customer Care Number: 1912
Customer Care E-mail: 1912@pspcil.in
Customer Care E-mail: helpdesk-pspci@pspcil.in

LOGIN TO VIEW RECEIPT FOR 3002811737

J) Taxation											
Electricity Duty	Municipal Tax	IDF	Govt. Cess	Total Tax	Net Energy Charges	TCS/TDS	Current Rounding Amount	NET BILL AMOUNT			
36604.00	5631.00	14078.00	0.00	56313		0.00		Rs. 339890/-	Three Lakh Thirty Nine Thousand Eight Hundred Sixty Rupees Only		
K) Total Billed Amount											
Due Date by Cash/Online	Due Date by DD/Cheque	Net Amount Payable by due date	Simple interest on delayed payment @1.5% p.m.			Amount Payable within 1 month after due date					
09-Oct-2023	05-Oct-2023	339890	5098			344958					
L) Previous Cycle's Consumption											
MONTH/SEP. 22	OCT-22	NOV-22	DEC-22	JAN-23	FEB-23	MAR-23	APR-23	MAY-23	JUN-23	JUL-23	AUG-23
MCI 98	46	46	32	38	51	43	138	80	80	59	174
KVAH 137314	-	9946	9146	8712	11382	9720	11090	21956	7576	11722	29426
KVAH 38250	10298	11004	10054	9430	12222	10528	12174	22866	8082	12276	30018
Payment History:											
Last Payment Amount Rs. 327070. Dated: 28-08-2023											
Message:											
<ol style="list-style-type: none"> 1. Payments exceeding Rs.20,000/- shall be accepted in digital mode only w.e.f 01-07-2021. 2. In case the payment of billed amount is not made by the due date, the power supply shall be liable for disconnection after expiry of 15 days of the due date and this may be taken as notice under section 56 of the Electricity Act 2003 read with regulation 32 of the Supply Code, 2014. 3. CHARGES HAS BEEN CHARGED AS ED @ 13% OF SOP, MT @ 2% OF SOP, IDF @ 5% OF SOP, CONCESSION @ 1 OR 2 PAISA PER KVAH/KVAH 4. - UNPAID DUES - A) LATE PAYMENT SURCHARGES : 0 B) LATE PAYMENT INTEREST : 0 5. LATE PAYMENT INTEREST @1.5% PER MONTH ON GROSS UNPAID AMOUNT OF THE BILL TILL DEPOSIT OF OUTSTANDING AMOUNT AFTER DUE DATE SHALL BE CHARGED 											
Description (SRN Code)	Quantity	UQC	Non-Taxable Amount	Taxable Amount	CGST 9%	SGST 9%	Total				
Meter Rent (967319)	1	-	0	1264	113.76	113.76	1491.52				
MCB Rent (967319)	1	-	0	0	0	0	0				
Electrical Energy (271600)	31208	UNIT-Units	0	0	0	0	0				
Powered by Oro C&T) PSPCL											
Print Date: 09-29-2023 05:37 PM											

6

PUNJAB STATE POWER CORPORATION LIMITED (Regd. Office P.S.E.B. Head Office, The Mall Patiala-147001 Ph. 1912). CN: U40109PB2010SG033813 E-mail: 1912@pspc.in, Website: www.pspd.in, GSTIN NO: 03AAFGP5129Q1ZC Original for Recipient Duplicate for Supplier, Taxable Invoice, Invoice-cum-Bill of Supply										Billing Category		
Sub Division										GSC/SAP-NONBEM-BS HT BULK SUPPLY DPC		
SUB DIVISION(T/UNIT-2)		Division	Circle	Bill Cycle	Bill Date	Bill No.						
MODEL TOWN SPECIAL D			WEST QTY LUDHIANA	09-2023	23-SEP-2023	50022531236						
AVC No.: 3902811737 Consumer Name: MS PRIN. GNK COLLEGE (W) Address: GUJAROHAN CAMPUS MTOWN LUDHIANA, 141001-INDIA GST No.: Connection Date: 10-08-2011 Mobile No.: 950000435				Load	Contract Demand	Tariff Type	Bill Status	Due Date	Bill Amount			
				174.203		BS HT BULK SUPPLY DPC	0	22-SEP-2023	05-SEP-2023	Rs. 339849/-		
Feeder Code Date of New Reading Date of Old Reading Bill Period Meter Security Security Cons Security cons/Meter Security Interest				Details of Meter Meter Number Make Capacity Digit Meter Status CT Make CT No.								
FDC000001820				11.00			12466206			L&T		
22-SEP-2023				22-AUG-2023			31			0		
22-SEP-2023				22-AUG-2023			31			0		
Meter Reading												
Details	Old Reading	New Reading	Current Units	Meter Multiplier	Line CT Ratio	Meter CT Ratio	Overall Multiplier	MMTS Correction	Old Meter Cons.	Unit Consumed		
KVAH	949435.00	965039.00		1.00	10/5	5/5	2.00			31208		
KVAH	1005363.00	1021329.00		1.00	10/5	5/5	2.00			31932		
MDI	87.408	87.497		1.00	10/5	5/5	2.00			174.996		
(A) Fixed Charges												
Contract Demand (L) KVA	Actual Demand KVA (A)	80% of (L) KVA (B)	A or B whichever greater KVA (C)	Rate per KVA per month (₹)	Billing Days (D)	A. Fixed Charges Amount -Ofs/Ont/365						
	174.996	139.36	174.2	340.00	31	60365.00						
(B) Energy Charges												
	Units	Rate/WWh	Amount	B. Total Energy Charges								
0-100	0		0.00	216499								
100-300	0		0.00									
300-500	0		0.00									
500 & ABOVE	0		0.00									
(C) Fuel Cost Adjustment Charges												
Total Energy Charges	KVAH Consumption	Rate of FCS/KVAH	C. Amount	Unit	Rate	Amount	C. FCA + Addl Surcharges					
216499			0.00			0.00	216499					
(D) Rental Charges												
Meter Rent for PSPCL Meter	MCB, CT/PT Unit Rental	Rent for any other equipment	Total Rent	HSN Code	SGST	CGST	Total GST	D. Total Rent with Tax				
1264	0		1264		113.76	113.76	227.52	1491.52				
(E) Surcharges												
Voltage Surcharge			Demand Surcharge			ToD Surcharge						
Supply Voltage	Catered Voltage	Surcharge Rate	Voltage Surcharge Amount	Demand in excess	Rate of Demand Surcharge	Amount of Demand Surcharge	Peak Hours KVAH	Rate	Amount	E. Total Surcharge (Rs.)		
11.00	11.00			0.79	750.00	595.00	2352.00	2.00	4704.00	5299.00		
(F) Rebates												
Voltage Rebates						ToD Rebates						
Units	HT/EHT Rebate	Amount	Non-Peak Hours KVAH	Rate	Amount	F. Total Rebates (Rs.)						
0.00	0.00	0.00	0.00		0.00	0.00						
(G) Previous Adjustment Amount Notice No. and Date:												
Units	Fixed Charges	Energy Charges	FCA	Rentals	Surcharges(+)	Rebates(-)	Taxes	Subsidy	Total	G. Net Previous Adjustment (Rs.)		
	/	/	/	/	/	/	0		0-100	0-100		
(H) Sundry Charges/Allowances Notice No. and Date: -												
Late Payment Interest	Units	Fixed Charges	Energy Charges	FCA	Rentals	Surcharges(+)	Rebates(-)	Taxes	Subsidy	Total	H. Net Sundry Charges/Allowances (Rs.)	
	/	/	/ 0	/ 0	/ 0	/	/ 0	/ 0	/	/ 0	/ 0	
(I) Subsidy												
Subsidized KVAH	Rate for Subsidy		Amount			I. Net Subsidy (Rs.)						
31932	0.00		0.00			0.00						

(J) Taxation								
Electricity Duty	Municipal Tax	IDF	Cow Cess	Total Tax	Net Energy Charges	TCS/TDS	Cum-Flex Rounding Amount	NET BILL AMOUNT
35232.00	5420.00	13551.00	0.00	54203		0.00		Rs. 327879/-
								Three Lakh Twenty Seven Thousand Seventy Eight Only

(K) Total Billed Amount				
Due Date by Cash/Online	Due Date by DD/Cheque	Net Amount Payable by due date	Simple interest on delayed payment @1.5% p.m.	Amount Payable within 1 month after due date
05-Sep-2023	05-Sep-2023	327070	4906	331976

(L) Previous Cycle's Consumption												
MONTH	SEP-22	OCT-22	NOV-22	DEC-22	JAN-23	FEB-23	MAR-23	APR-23	MAY-23	JUN-23	JUL-23	AUG-23
MDI-98	96	96	46	32	38	51	43	138	80	80	59	174
KWH-37314	-	10298	9946	9146	8712	11362	9720	11096	21956	7576	11722	29428
KVAH-38250	-	10298	11004	10054	9430	12222	10528	12174	22866	8092	12276	30018

Payment History:
Last Payment Amount Rs 160550, Dated: 26-07-2023

- Message:
1. Payments exceeding Rs.20,000/- shall be accepted in digital mode only w.e.f 01-07-2021.
 2. In case the payment of billed amount is not made by the due date, the power supply shall be liable for disconnection after expiry of 15 days of the due date and this may be taken as notice under section 56 of the Electricity Act 2003 read with regulation 32 of the Supply Code, 2014.
 3. CHARGES HAS BEEN CHARGED AS ED @ 13% OF SOP, MT @ 2% OF SOP, IDF @ 5% OF SOP, CONCESS @ 1 OR 2 PAISA PER KWH/KVAH
 4. - UNPAID DUES - A) LATE PAYMENT SURCHARGES : 0 B) LATE PAYMENT INTEREST : 0
 5. LATE PAYMENT INTEREST @1.5% PER MONTH ON GROSS UNPAID AMOUNT OF THE BILL TILL DEPOSIT OF OUTSTANDING AMOUNT AFTER DUE DATE SHALL BE CHARGED.

Description (HSN Code)	Quantity	UOC	Non-Taxable Amount	Taxable Amount	CGST 9%	SGST 9%	Total
Meter Rent (997319)	1	-	0	1264	113.76	113.76	1491.52
MCB Rent (997319)	1	-	0	0	0	0	0
Electrical Energy (271900)	29428	UNT-Units	0	0	0	0	0

PUNJAB STATE POWER CORPORATION LIMITED
 (Regd. Office P.S.E.B. Head Office, The Mall, Patiala-147001, Ph: 1912). Cite: U61059PB201680033613
 E-mail: 1912@pspc.in, Website: www.pspd.in, GSTIN NO: 03AAFCP5120Q1ZC
 Original for Recipient Duplicate for Supplier, Taxable Invoice, Invoice-cum-Bill of Supply

Billing Category
GSC/SAP/NonSBM/BS HT BULK SUPPLY DPC

Sub Division	Division	Circle	Bill Cycle	Bill Date	Bill No.	
SUB DIVISION(T)/UNIT-2	MODEL TOWN SPECIAL D	WEST CITY LUDHANA	09-2023	23-AUG-2023	90022311529	
A/C No.: 3062811737 Consumer Name: M/S PRIN GNK COLLEGE (W) Address: GUJARANAHAN CAMPUS MTOWN LUDHANA-141001-INDIA	Load	Contract Demand	Tariff Type	Bill Status	Due Date	
GST No.: Connection Date: 10-08-2011 Mobile No.: 950000435	174.203		BS-HT BULK SUPPLY DPC	0	09-Sep-2023	
					05-Sep-2023	
	Voltage Supply	Details of Meter			Bill Amount	
	11.00	Meter Number	Make	Capacity	Digit	
		12466206	L&T	5-6	8	
					Meter Status	
					CT Make	
					CT No.	
Feeder Code	Date of New Reading	Date of Old Reading	Bill Period	Meter Security	Security Cons	
FDC0000001620	22-AUG-2023	21-JUL-2023	32	0	248866	
Meter Reading						
Details	Old Reading	New Reading	Current Units	Meter Multiplier	Line CT Ratio	
KWH	904721.00	949435.00		1.00	10/5	
KVAH	960354.00	1005363.00		1.00	10/5	
MCI	29.6	87.408		1.00	10/5	
					Meter CT Ratio	
					Overall Multiplier	
					MMTS Connection	
					Old Meter Cons	
					Unit Consumed	
					29428	
					30016	
					174.816	
(A) Fixed Charges						
Contract Demand (L) KVA	Actual Demand KVA (A)	80% of (L) KVA (B)	A or B whichever greater KVA (C)	Rate per KVA per month (R)	Billing Days (D)	
	174.816	139.86	174.2	340.00	32	
(B) Energy Charges						
	Units	Rate/Wh	Amount	B. Total Energy Charges		
0-100	0		0.00	203522		
100-300	0		0.00			
300-500	0		0.00			
500 & ABOVE	0		0.00			
(C) Fuel Cost Adjustment Charges						
Total Energy Charges	KVAH Consumption	Rate of FCS/KVAH	C Amount	Unit	Rate	
203522			0.00			
(D) Rental Charges						
Meter Rent for PSPCL Meter	MOB, CT/PT Unit Rental	Rent for any other equipment	Total Rent	HSN Code	SGST	
1264	0		1264		113.76	
(E) Surcharges						
	Voltage Surcharge		Demand Surcharge		ToD Surcharge	
Supply Voltage	Contract Voltage	Surcharge Rate	Voltage Surcharge Amount	Demand in excess	Rate of Demand Surcharge	
11.00	11.00			0.61	750.00	
					Amount of Demand Surcharge	
					Peak Hours KVAH	
					Rate	
					Amount	
					E. Total Surcharge (Rs.)	
					5180.00	
					5640.00	
(F) Rebates						
	Voltage Rebates			ToD Rebates		
Units	HT/EHT Rebate	Amount	Non-Peak Hours KVAH	Rate	Amount	
0.00	0.00	0.00	0.00		0.00	
(G) Previous Adjustment Amount						
Units	Fixed Charges	Energy Charges	FCA	Rentals	Surcharge(+)	
	/	/	/	/	/	
					Rebates(-)	
					Taxes	
					Subsidy	
					Total	
					G. Net Previous Adjustment (Rs.)	
					0-100	
					0-100	
(H) Sundry Charges/Allowances						
Late Payment Interest	Units	Fixed Charges	Energy Charges	FCA	Rentals	
	/	/	/	/	/	
					Surcharge(+)	
					Rebates(-)	
					Taxes	
					Subsidy	
					Total	
					H. Net Sundry Charges/Allowances (Rs.)	
					/	
					/	
					/	
					/	
(I) Subsidy						
Subsidised KVAH	Rate for Subsidy	Amount	I. Net Subsidy (Rs.)			
30016	0.00	0.00	0.00			



Punjab State Power Corporation Ltd.

Bill Payment Successful !
Below are the payment details.

Consumer Name	M/S
Account No.	3002811737
Bill Due Date	
Transaction Date	25 JUL, 2023
Receipt No.	195821986
Gateway Ref. No.	SBI2307250000721
Bill Category	BS HT BULK SUPPLY DPC
Bill Cycle/Group	0/0
Sub Division Name	
Amount Paid	Rs.160550/-
Amount in Words	One Lakh Sixty Thousand Five Hundred Fifty Rupees Only
Payment Status	Amount Realized.

"If you don't optimize for the consumer on the Internet, you're dead."
Thanks for the payment

Best Regards,
PSPCL IT Team.
Customer Care Number: 1912
Customer Care E-mail: 1912@pspcl.in
Customer Care E-mail: helpdesk-pspcl@pspcl.in

LOGIN TO VIEW RECEIPT FOR 3002811737

L) Taxation											
Electricity Duty	Municipal Tax	ICF	Cow Class	Total Tax	Net Energy Charges	TCS/TDS	Com/Pre Rounding Amount	NET BILL AMOUNT			
17242.00	2653.00	6632.00	0.00	26527		0.00		Rs. 149150 One Lakh Sixty Thousand Five Hundred Fifty Rupees Only			
P) Total Billed Amount											
Due Date by Cash/Online	Due Date by DD/Cheque	Net Amount Payable by due date	Simple interest on delayed payment @ 5% p.m.			Amount Payable within 1 month after due date					
26-Aug-2023	04-Aug-2023	180550	2438			162956					
Q) Previous Cycle's Consumption											
MONTH/JUL-22	AUG-22	SEP-22	OCT-22	NOV-22	DEC-22	JAN-23	FEB-23	MAR-23	APR-23	MAY-23	JUN-23
MDI 109	103	98	98	46	32	38	51	43	138	80	80
KVAH23950	-	37314	9645	9646	9146	8712	11362	9720	11096	21956	7576
KVAH24655	15486	36250	10298	11004	10954	9430	12222	10528	12174	22666	8092
Payment History:											
Last Payment Amount Rs. 179620. Dated: 26-06-2023.											
Message:											
<ol style="list-style-type: none"> 1. Payments exceeding Rs.20,000/- shall be accepted in digital mode only w.e.f. 01-07-2021. 2. In case the payment of billed amount is not made by the due date, the power supply shall be liable for disconnection after expiry of 15 days of the due date and this may be taken as not in order under section 56 of the Electricity Act 2003 read with regulation 32 of the Supply Code, 2014. 3. CHARGES HAS BEEN CHARGED AS ED @ 13% OF SOP, MT @ 2% OF SOP, ICF @ 5% OF SOP, COM/RESS @ 1 OR 2 PAISA PER KVAH/KVAH 4. - UNPAID DUES - A) LATE PAYMENT SURCHARGES : 0 B) LATE PAYMENT INTEREST : 0 5. LATE PAYMENT INTEREST @ 5% PER MONTH ON GROSS UNPAID AMOUNT OF THE BILL TILL DEPOSIT OF OUTSTANDING AMOUNT AFTER DUE DATE SHALL BE CHARGED. 											
Description (HSN Code)	Quantity	LOC	Non-Taxable Amount	Taxable Amount	CGST 9%	SGST 9%	Total				
Meter Rent (997319)	1	-	0	1264	113.76	113.76	1491.52				
MCB Rent (997319)	1	-	0	0	0	0	0				
Electrical Energy (271600)	11722	UNIT-Units	0	0	0	0	0				
Powered by Ojo CE(IT) PSPCL											
Print Date: 07-04-2023 11:16 PM											

4

PUNJAB STATE POWER CORPORATION LIMITED (Regd. Office P.S.E.B. Head Office, The Mall Patiala-147001, Ph. 1912; CIN: U40109PB2010SC033813 E-mail: 1912@pspcd.in, Website: www.pspcd.in, GSTIN NO: 63AAFCP5120Q1ZC Original for Recipient Duplicate for Supplier, Taxable Invoice, Invoice-cum-Bill of Supply										Billing Category	
Sub Division										GSC/SAP-NONSIM-BS HT BULK SUPPLY DPC	
SUB DIVISION(T)/UNIT-2		Division		Circle		Bill Cycle		Bill Date		Bill No.	
MODEL TOWN SPECIAL D		WEST CITY LUDHIANA		07-2023		24-JUL-2023		50219043312			
A/C No.: 3002811737 Consumer Name: M'S PRIN GNK COLLEGE (W) Address: GUJAR/KHAN CAMPUS MITOWN LUDHIANA-141001-INDIA GST No.: Connection Date: 10-06-2011 Mobile No.: 9500000435		Load	Contract Demand	Tariff Type	Bill Status	Due Date		Bill Amount			
		174.203		BS HT BULK SUPPLY DPC	0	08-Aug-2023	04-Aug-2023	Rs. 199550/-			
		Voltage Supply		Details of Meter				Meter Status	CT Make	CT No.	
11.00		12466206	L&T	5-6	8	0	858				
Feeder Code		Date of New Reading		Date of Old Reading		Bill Period		Meter Security		Security cons/Meter Security Interest	
FDC0000001620		21-JUL-2023		21-JUN-2023		30		0		266666	
Meter Reading											
Details	Old Reading	New Reading	Current Units	Meter Multiplier	Line CT Ratio	Meter CT Ratio	Overall Multiplier	MMTS Correction	Old Meter Cons	Unit Consumed	
KWH	928860.00	934721.00		1.00	10/5	5/5	2.00			11722	
KVAH	984216.00	990354.00		1.00	10/5	5/5	2.00			12275	
MCI	40.395	29.6		1.00	10/5	5/5	2.00			59.2	
(A) Fixed Charges											
Contract Demand (L) KVA		Actual Demand KVA (A)		80% of (L) KVA (B)		A or B whichever greater KVA (C)	Rate per KVA per month (R)	Billing Days (D)		A. Fixed Charges Amount =CxDxR/12/365	
		59.2		139.36		139.36	340.00	30		46734.00	
(B) Energy Charges											
			Units		Rate/WWh		Amount		B. Total Energy Charges		
0-100			0				0.00		83231		
100-300			0				0.00				
300-500			0				0.00				
500 & ABOVE			0				0.00				
(C) Fuel Cost Adjustment Charges											
Total Energy Charges		KVAH Consumption		Rate of FCS/KVAH	C. Amount	Unit	Rate	Amount	C. FCA + Addl Surcharges		
83231				0.00				0.00	83231		
(D) Rental Charges											
Meter Rent for PSPCL Meter		MCB, CT/PT Unit Rental	Rent for any other equipment		Total Rent		HSN Code	SGST	CGST	Total GST	D. Total Rent with Tax
1264		0			1264			113.76	113.76	227.52	1491.52
(E) Surcharges											
Voltage Surcharge			Demand Surcharge			ToD Surcharge					
Supply Voltage	Catered Voltage	Surcharge Rate	Voltage Surcharge Amount	Demand in excess	Rate of Demand Surcharge	Amount of Demand Surcharge	Peak Hours KVAH	Rate	Amount	E. Total Surcharge (Rs.)	
11.00	11.00			0.00	0.00	0.00	1334.00	2.00	2668.00	2668.00	
(F) Rebates											
Voltage Rebates						ToD Rebates					
Units		HT/EHT Rebate		Amount		Non-Peak Hours KVAH		Rate	Amount	F. Total Rebates (Rs.)	
0.00		0.00		0.00		0.00			0.00	0.00	
(G) Previous Adjustment Amount Notice No. : and Date: -											
Units	Fixed Charges	Energy Charges	FCA	Rentals	Surcharges(+)	Rebates(-)	Taxes	Subsidy	Total	G. Net Previous Adjustment (Rs.)	
	/4.22			/			/0		0/-104.22	0/-104.22	
(H) Sundry Charges/Allowances Notice No. : - and Date: -											
Late Payment Interest	Units	Fixed Charges	Energy Charges	FCA	Rentals	Surcharges(+)	Rebates(-)	Taxes	Subsidy	Total	H. Net Sundry Charges/Allowances (Rs.)
	/	/	/0	/0	/0	/	/0	/0	/	/0	/0
(I) Subsidy											
Subsidised KVAH		Rate for Subsidy		Amount		I. Net Subsidy (Rs.)					
12275		0.00		0.00		0.00					

4

PUNJAB STATE POWER CORPORATION LIMITED Regd. Office P.S.E.B. Head Office, The Mall Patiala-147001, Ph: 1912, CIN: U46109PB2010G033813 E-mail: 1912@pspcd.in, Website: www.pspcd.in, GSTIN NO: 03AAFCP5120Q12C Original for Recipient Duplicate for Supplier, Taxable Invoice, Invoice-cum-Bill of Supply										Billing Category		
Sub Division										GSC/SAP-NONSBM-BS HT BULK SUPPLY DPC		
Sub Division (TY/UNIT-2)		Division	Circle	Bill Cycle	Bill Date	Bill No.						
MODEL TOWN SPECIAL D			WEST CITY LUDHIANA	07-2023	24-JUL-2023	50219043312						
A/C No.: 3002811737 Consumer Name: M'S PRIN GNK COLLEGE (W) Address: GULSHAN CAMPUS M/TOWN LUDHIANA-141001-INDIA GST No.: Connection Date: 10-08-2011 Mobile No.: 95XXXXX435				Load	Contract Demand	Tariff Type	Bill Status	Due Date	Due Date	Bill Amount		
				174.203		BS HT BULK SUPPLY DPC	0	08-Aug-2023	04-Aug-2023	Rs. 160550/-		
Voltage Supply				Details of Meter				Meter Status	CT Make	CT No.		
				Meter Number	Make	Capacity	Digit					
				11.00	12466205	L&T	5-6	8	0	858		
Feeder Code		Date of New Reading		Date of Old Reading		Bill Period	Meter Security	Security Cons	Security cons/Meter Security Interest			
FDC000001620		21-JUL-2023		21-JUN-2023		30	0	246666				
Meter Reading												
Details	Old Reading	New Reading	Current Units	Meter Multiplier	Line CT Ratio	Meter CT Ratio	Overall Multiplier	MMTS Correction	Old Meter Cons	Unit Consumed		
KWH	928860.00	934721.00		1.00	10/5	5/5	2.00			11722		
KVAH	984216.00	990354.00		1.00	10/5	5/5	2.00			12276		
MDI	40.395	29.6		1.00	10/5	5/5	2.00			59.2		
(A) Fixed Charges												
Contract Demand (L) KVA		Actual Demand KVA (A)		80% of (L) KVA (B)		A or B whichever greater KVA (C)		Rate per KVA per month (F)	Billing Days (D)	A. Fixed Charges Amount = (C) x (D) x (F)		
		59.2		139.36		139.36		340.00	30	46734.00		
(B) Energy Charges												
			Units	Rate/W/h		Amount		B. Total Energy Charges				
0-100			0			0.00		83231				
100-300			0			0.00						
300-500			0			0.00						
500 & ABOVE			0			0.00						
(C) Fuel Cost Adjustment Charges												
Total Energy Charges		KVAH Consumption		Rate of FCS/KVAH	C. Amount	Unit	Rate	Amount	C. FCA + Addl Surcharges			
83231					0.00			0.00	83231			
(D) Rental Charges												
Meter Rent for PSPCL Meter		MCB, CT/PT Unit Rental	Rent for any other equipment	Total Rent		HSN Code	SGST	CGST	Total GST	D. Total Rent with Tax		
1264		0		1264			113.76	113.76	227.52	1491.52		
(E) Surcharges												
Voltage Surcharge			Demand Surcharge			ToD Surcharge						
Supply Voltage	Calend Voltage	Surcharge Rate	Voltage Surcharge Amount	Demand in excess	Rate of Demand Surcharge	Amount of Demand Surcharge	Peak Hour KVAH	Rate	Amount	E. Total Surcharge (Rs.)		
11.00	11.00			0.00	0.00	0.00	1334.00	2.00	2668.00	2668.00		
(F) Rebates												
Voltage Rebates					ToD Rebates							
Units		HT/EHT Rebate	Amount	Non-Peak Hours KVAH		Rate	Amount	F. Total Rebates (Rs.)				
0.00		0.00	0.00	0.00			0.00	0.00				
(G) Previous Adjustment Amount												
Units		Fixed Charges	Energy Charges	FCA	Rentals	Surcharge(+)	Rebate(-)	Taxes	Subsidy	Total	G. Net Previous Adjustment (Rs.)	
		/-4.22						0		0/-104.22	0/-104.22	
(H) Sundry Charges/Allowances												
Late Payment Interest		Units	Fixed Charges	Energy Charges	FCA	Rentals	Surcharge(+)	Rebate(-)	Taxes	Subsidy	Total	H. Net Sundry Charges/Allowances (Rs.)
		/	/	/0	/0	/0	/	/0	/0	/	/0	/0
(I) Subsidy												
Subsidised KVAH		Rate for Subsidy		Amount		I. Net Subsidy (Rs.)						
12276		0.00		0.00		0.00						

Punjab State Power Corporation Ltd.

Bill Payment Successful !
Below are the payment details.

Consumer Name	M/S
Account No.	3002811737
Bill Due Date	
Transaction Date	27 JUN, 2023
Receipt No.	194906421
Gateway Ref. No.	SBI2306270001179
Bill Category	BS HT BULK SUPPLY DPC
Bill Cycle/Group	0/0
Sub Division Name	
Amount Paid	Rs.179620/-
Amount in Words	One Lakh Seventy Nine Thousand Six Hundred Twenty Rupees Only
Payment Status	Amount Realized.

"The road to success is always under construction."
Thanks for the payment

Best Regards,
PSPCL IT Team,
Customer Care Number: 1912
Customer Care E-mail: 1912@pspcl.in
Customer Care E-mail: helpdesk-pspci@pspcl.in

LOGIN TO VIEW RECEIPT FOR 3002811737

✓
284

The Manager,
Indian Bank,
Model Town
Ludhiana

27/06/2023.

Subject : Payment of Electricity bill PSPCL for the period 22/05/2023 to 23/06/23

Kindly debit a sum of 179620/- (Rs One Lac, seventy nine thousand, six hundred and twenty only) to our SB A/c No 463430129 and transfer this amount through RTGS to

**Punjab State Power Corporation Limited PSPCLA3002811737MP IFSC code SBIN
0004266 SBI,CMP,Central Mumbai.**

Consumer details
Electricity A/c No 3002811737
Principal, G.N.Kh.College for Women,
9501017435 (M)
Email ld-gnkcwldh@rediffmail.com
Sub division code 2453
Division code-245.

Yours Sincerely,

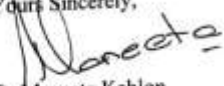
Dr. Maneeta Kahlon
Principal Principal
G.N. Kh. College for Women
Model Town, LUDHIANA



rediffmail

Mailbox of gpkowdh1

Subject: Your Electricity Bill For Account 3002811737

From: PSPCL DoNotReply <onlinebill@pspcl.in> on Sun, 25 Jun 2023 05:50:14

To: <gpkowdh1@rediffmail.com>

1 attachment(s) - 3002811737_10-JUL-2023.pdf (51.28KB)



Dear consumer, greetings from PSPCL...

Your bill is due with PSPCL, check below details.

Account Number	3002811737
Due Amount	Rs.179620/-
Due Date	10-JUL-2023
<input type="button" value="PAY NOW"/>	

Some Useful Tips:

You can make payment through PSPCL bill payment portal by clicking PAY NOW button.

Bill copy (pdf) is attached herein this email for your reference.

Bill details has also been sent to your mobile no.

95XXXXX435. [Click Here](#) for updating your mobile no./email.

If you have bill payment related questions, please contact us.

Rs. 179620/-
Dancee
Principals

G.N. Kh. College for Women,
Model Town, LUDHIANA.

26/6/23

Regards,

PSPCL IT Team.

Customer Care Number: 1912

Customer Care E-mail: 1912@pspcl.in

Customer Care E-mail: helpdesk-pspci@pspcl.in

A/C No.: 3002811737		Bill No. 50021797250		Page No. 2	
Subsidized KVAH		(H) Subsidy PHP/FC Subsidy		Amount	
		0.00			
(I) Open Access Charges (Applicable to LS Open Access Consumers)					
Total Consumption (KVAH)	PSPCL Consumption	OA Consumption	Cross Subsidy Charges	Additional Surcharge	LT Charges
8092	8,092.00				
(J) Taxation					
Electricity Duty		Municipal Tax		ED	Concess
11623		1788		4470	
Current Bill Amount (Rs.): A + B + C + D + E + F - G - H + I + J, = 108331.30					TCS/TDS : 0.00

BILL AMOUNT:	SOP	Rentals	ED	InfraCess	CC	MT	Misc + LT/TCS/TDS	Total
Current Charges	89410.9	1044.3	11623	4470		1788		108336.2
Unpaid arrears	56067.52	379.00	7,252.00	3497.48	0.00	4020.00		71216

BILL AMOUNT:	Units	Notice No./Date	SOP	Rentals	ED	InfraCess	CC	MT	Misc + LT/TCS/TDS	Total
Adjustment								68.22		68.22
Sundry Charges										
Sundry Allow.										

BILL AMOUNT:	SOP	Rentals	ED	InfraCess	CC	MT	Misc + LT/TCS/TDS	Total
Net Amount	145478.42	1425.3	18875	7967.48	0	5876.22		179620.42
Total Amount Payable	ONE LAKH SEVENTY NINE THOUSAND SIX HUNDRED TWENTY Rupees							Rs. 179620
Late Payment Interest @ 1.5% per month on gross unpaid amount of bill till the deposit of outstanding amount after due date shall be charged.								Round Amount Curr/Prev -0.42 / 4.9

Net Bill Amount	Due date by Online/RTGS	Net Amount Payable by Due	Simple Interest on delayed payment @ 1.5% p.m.	Amount Payable within 1 Month after due date
179620	10.07.2023	179620	2694	182314

Prev. Payment Status	
Prev. Payment Total (Rs.)	Payment Date
168990.00	25.05.2023

Description/HSN Code	Quantity	UNT-Units	Non-Taxable Amount	Taxable Amount	CGST 9%	SGST 9%	Total
Meter Rent (997319)	1		0.00	885	79.65	79.65	1,044.30
MCB Rent (997319)	1		0.00	0.00	0.00	0.00	0.00
Electrical Energy(271600)	7576		89,410.90	0	0	0	89,410.90
Service Rent(997319)					0.00	0.00	0.00

Consumption History for the previous 12 months period												
Month	JUN-22	JUL-22	AUG-22	SEP-22	OCT-22	NOV-22	DEC-22	JAN-23	FEB-23	MAR-23	APR-23	MAY-23
MDI	131	109	103	98	98	46	32	38	51	43	138	80
KWH	18442		14486	37314	9646	9946	9146	8712	11362	9720	11096	21956
KVAH	18988	24666	15466	38250	10298	11004	10054	9430	12222	10528	12174	22866
PF												

Messages:-
 - Unpaid Dues :- a) Late Payment Surcharges : 58 b) Late Payment Interest : 0
 Late Payment interest @1.5% per month on gross unpaid amount of the bill till deposit of outstanding amount after due date shall be charged.
 - Notice :- In case the payment of billed amount is not made by the due date, the power supply shall be liable for disconnection after expiry of 15 days of the due date and this may be taken as notice under section 56 of the Electricity Act 2003 read with regulation 32 of the Supply Code, 2014. Further, whosoever unauthorizedly makes connection shall be punishable with imprisonment upto three years and/ or fine upto Rs. 10000/- as per Section 138 of the Electricity Act, 2003.



Punjab State Power Corporation Ltd.

Bill Payment Successful !
Below are the payment details.

Consumer Name	M/S
Account No.	3002811737
Bill Due Date	
Transaction Date	24 MAY, 2023
Receipt No.	194030990
Gateway Ref. No.	SBI2305240000194
Bill Category	BS HT BULK SUPPLY DPC
Bill Cycle/Group	0/0
Sub Division Name	
Amount Paid	Rs.168990/-
Amount in Words	One Lakh Sixty Eight Thousand Nine Hundred Ninety Rupees Only
Payment Status	Amount Realized.

"A man without a smiling face must not open a shop."
Thanks for the payment

Best Regards,
PSPCL IT Team,
Customer Care Number: 1912
Customer Care E-mail: 1912@pspcl.in
Customer Care E-mail: helpdesk-pspcl@pspcl.in

LOGIN TO VIEW RECEIPT FOR 3002811737

(2)

PUNJAB STATE POWER CORPORATION LIMITED (Regd. Office P.S.E.B. Head Office, The Mall Patiala-147001 Ph. 1912), CIN: U01109PB29108GG933813 E-mail: 1912@pspcd.in, Website: www.pspcd.in, GSTIN NO: 83AAFCP5129G1ZC Original for Recipient Duplicate for Supplier, Taxable Invoice, Invoice-cum-Bill of Supply										Billing Category													
Sub Division										Division		Order		Bill Cycle		Bill Date		Bill No.					
SUB DIVISION(TY)UNIT-2										MODEL TOWN SPECIAL D		WEST CITY LUDHIANA		05-2023		22-MAY-2023		51412500558					
AVC No.: 3002811737 Consumer Name: M/S PRIN GNK COLLEGE (M) Address: GUJAROHAN CAMPUS MITOWN LUDHIANA-141001 INDIA										Load		Contract Demand		Tariff Type		Bill Status		Due Date		Bill Amount			
										174.203				BS HT BULK SUPPLY DPC		0		06-Jun-2023		02-Jun-2023		Rs. 166995/-	
GST No.: Connection Date: 10-08-2011 Mobile No.: 950000X435										Voltage Supply		Details of Meter		Capacity		Digit		Meter Status		CT Make		CT No.	
										11.00		12466206		L&T		5-6		5		0		858	
Feeder Code			Date of New Reading			Date of Old Reading			Bill Period		Meter Security		Security Cons.		Security cons/Meter Security Interest								
FDC0000001620			22-MAY-2023			22-APR-2023			30		0		248696										
Meter Reading																							
Details		Old Reading		New Reading		Current Units		Meter Multiplier		Line CT Ratio		Meter CT Ratio		Overall Multiplier		MMTS Correction		Old Meter Cons.		Unit Consumed			
KVAH		914094.00		921996.00				1.00		10/5		5/5		2.00						15804			
KVAH		968737.00		1077007.00				1.00		10/5		5/5		2.00						16540			
MCI		69.465		45.551				1.00		10/5		5/5		2.00						91.102			
(A) Fixed Charges																							
Contract Demand (L) KVA		Actual Demand KVA (A)		80% of (L) KVA (B)		A or B whichever greater KVA (C)		Rate per KVA per month (R)		Billing Days (D)		A: Fixed Charges Amount =C/Rx12/365											
		91.102		139.36		139.36		300.00		30		41236.00											
(B) Energy Charges																							
										Units		Rate/Wh		Amount		B: Total Energy Charges							
0-100										0				0.00		105525							
100-300										0				0.00									
300-500										0				0.00									
500 & ABOVE										0				0.00									
(C) Fuel Cost Adjustment Charges											*Additional Surcharges												
Total Energy Charges		KVAH Consumption		Rate of FCS/KVAH		C: Amount		Unit		Rate		Amount		C: FCA + Addl Surcharges									
105525						0.00						0.00		105525									
(D) Rental Charges											GST												
Meter Rent for PSPCL Meter		MCB, CT/PT Unit Rental		Rent for any other equipment		Total Rent		HGN Code		SGST		CGST		Total GST		D: Total Rent with Tax							
1264		0				1264				113.76		113.76		227.52		1491.52							
(E) Surcharges																							
Voltage Surcharge						Demand Surcharge						ToD Surcharge											
Supply Voltage		Catered Voltage		Surcharge Rate		Voltage Surcharge Amount		Demand in excess		Rate of Demand Surcharge		Amount of Demand Surcharge		Peak Hours KVAH		Rate		Amount		E: Total Surcharge (Rs.)			
11.00		11.00				0.00		0.00		0.00		0.00		0.00				0.00		0.00			
(F) Rebates																							
Voltage Rebates											ToD Rebates												
Units		HT/EHT Rebate		Amount		Non-Peak Hours KVAH		Rate		Amount		F: Total Rebates (Rs.)											
0.00		0.00		0.00		3894.00		1.25		4868.00		4868.00											
(G) Previous Adjustment Amount											Notice No.: - and Date: -												
Units		Fixed Charges		Energy Charges		FCA		Rentals		Surcharges(+)		Rebates(-)		Taxes		Subsidy		Total		G: Net Previous Adjustment (Rs.)			
		/2770																0-2770		0-2770			
(H) Sundry Charges/Allowances											Notice No.: - and Date: -												
Late Payment Interest		Units		Fixed Charges		Energy Charges		FCA		Rentals		Surcharges(+)		Rebates(-)		Taxes		Subsidy		Total		H: Net Sundry Charges/Allowances (Rs.)	
						/0		/0		/0				/0		/0				/0		/0	
(I) Subsidy																							
Subsidized KVAH				Rate for Subsidy				Amount				I: Net Subsidy (Rs.)											
16540				0.00				0.00				0.00											

The Manager,
Indian Bank,
Model Town
Ludhiana



24/4/2023

Subject : Payment of Electricity bill PSPCL for the period 22/03/2023 to 22/4/2023

Kindly debit a sum of 136860/- (**Rs One Lac, thirty six thousand, eight hundred and sixty only**) to our SB A/c No 463430129 and transfer this amount through RTGS to Punjab State Power Corporation Limited PSPCLA3002811737MP IFSC code SBIN 0004266 SBI,CMP,Central Mumbai.

Consumer details
Electricity A/c No 3002811737
Principal, G.N.Kh.College for Women,
9501017435 (M)
Email Id-gnkewldh@rediffmail.com
Sub division code 2453
Division code-245.

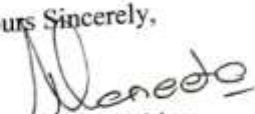
Yours Sincerely,

Dr. Maneeta Kahlon
Principal Principal
G.N. Kh. College for Women
Model Town, LUDHIANA. 

24/4/23

(J) Taxation								NET BILL AMOUNT
Electricity Duty /	Municipal Tax	IDF	Cow Cess	Total Tax	Net Energy Charges	TCS/TDS	Cur/Prev Rounding Amount	Rs. 13,600/-
15679.61	2412.00	6030.00	0.00	24121		0.00		One Lakh Thirty Six Thousand Eight Hundred Sixty Rupees Only

(K) Total Billed Amount								
Due Date by Cash/Online	Due Date by DD/Cheque	Net Amount Payable by due date	Late Payment Surcharge for LT consumer upto 15 days @2% of unpaid amount	Amount Payable by LT consumer upto 15 days after due date	Late Payment Surcharge for HT consumer upto 7 days after due date	Amount Payable by HT consumer upto 7 days after due date	Late Payment Surcharge for HT consumer upto 7 days @5% of unpaid amount	Amount Payable by HT consumer after 7 days & upto 15 days after due date
06-May-2023	04-May-2023	136860	2924	139784	7311	144171	2924	7311

Interest @ 1.5% per month on gross unpaid amount including surcharge shall be levied after 15 days from due date of bill.

(L) Previous Cycle's Consumption											
MONTH/APR-22	MAY-22	JUN-22	JUL-22	AUG-22	SEP-22	OCT-22	NOV-22	DEC-22	JAN-23	FEB-23	MAR-23
MDI-106	106	131	109	103	95	95	46	32	38	51	43
KVAH-18794	37062	18442	23950	14486	32314	9548	9946	9146	8712	11362	9720
KVAH-19786		18988	24686	15466	36250	10298	11004	10054	9430	12222	10528

Payment History:
Last Payment Amount Rs. 123270, Dated: 29-03-2023

- Message:**
1. Payments exceeding Rs.20,000/- shall be accepted in digital mode only w.e.f. 01-07-2021.
 2. In case the payment of billed amount is not made by the due date, the power supply shall be liable for disconnection after expiry of 15 days of the due date and this may be taken as notice under section 56 of the Electricity Act 2003 read with regulation 32 of the Supply Code, 2014.
 3. CHARGES HAS BEEN CHARGED AS ED @ 13% OF SOP, MT @ 2% OF SOP, IDF @ 5% OF SOP, CONCESS @ 1 OR 2 PAISA PER KWH/KVAH
 4. AMOUNT RS.10284.00- OF INTEREST ON SECURITY UP TO 31.03.2023
 5. - UNPAID DUES :- A) LATE PAYMENT SURCHARGES : 0 B) LATE PAYMENT INTEREST : 0
 6. AMOUNT RS.1028.00 OF TDS ON INTEREST AMOUNT

Description (HSN Code)	Quantity	UQC	Non-Taxable Amount	Taxable Amount	CGST 9%	SGST 9%	Total
Meter Rent (997319)	1	-	0	1264	113.76	113.76	1491.52
MCB Rent (997319)	1	-	0	0	0	0	0
Electrical Energy (271600)	11096	UNT-Units	0	0	0	0	0

Powered by Qlo CE(IT) PSPCL

Print Date: 04-22-2023 11:17 PM

1,36,860/-

[Signature]
Principal
G.N. Kh. College for Women,
Model Town, LUDHIANA.

[Signature]
24/4/23

4) Taxation												
Electricity Duty	Municipal Tax	IDF	Govt. Cess	Total Tax	Net Energy Charges	TCS/TDS	Govt. Prev. Rounding Amount	NET BILL AMOUNT				
17532.00	2697.00	6743.00	0.00	26972		0.00		Rs. 163230-				
90 Total Billed Amount												
Due Date by Cash/Online	Due Date by DD/Cheque	Net Amount Payable by due date	Simple interest on delayed payment @1.5% p.m.	Amount Payable within 1 month after due date								
11-Mar-2024	06-Mar-2024	163230	2448	165678								
5) Previous Cycle's Consumption												
MONTH	FEB-23	MAR-23	APR-23	MAY-23	JUN-23	JUL-23	AUG-23	SEP-23	OCT-23	NOV-23	DEC-23	JAN-24
MDL51	43	43	138	80	80	59	174	110	149	113	57	29
KWH11362	-	-	11096	21966	7576	11722	29428	38240	14228	8370	9236	9175
KVAH12222	10528	-	12174	22666	8092	12276	30018	39112	15068	9054	9752	9692
Payment History:												
Last Payment Amount: Rs. 137610, Dated: 26-01-2024												
Message:												
1. Payments exceeding Rs.20,000/- shall be accepted in digital mode only w.e.f. 01-07-2021. 2. In case the payment of billed amount is not made by the due date the power supply shall be liable for disconnection after expiry of 15 days of the due date and this may be taken as notice under section 56 of the Electricity Act 2003 read with regulation 32 of the Supply Code, 2014. 3. CHARGES HAS BEEN CHARGED AS ED @ 13% OF SOP, MT @ 2% OF SOP, IDF @ 5% OF SOP, CONCESS @ 1 OR 2 PAISA PER KWH/KVAH 4. ADJUSTMENT DETAIL WITH PERIOD: 5. -UNPAID DUES - A) LATE PAYMENT SURCHARGES : 0 B) LATE PAYMENT INTEREST : 0 6. LATE PAYMENT INTEREST @1.5% PER MONTH ON GROSS UNPAID AMOUNT OF THE BILL TILL DEPOSIT OF OUTSTANDING AMOUNT AFTER DUE DATE SHALL BE CHARGED.												
Description (HSN Code)	Quantity	UOC	Non-Taxable Amount	Taxable Amount	CGST 9%	SGST 9%	Total					
Meter Rent (997319)	1	-	0	1264	113.76	113.76	1491.52					
MCB Rent (997319)	1	-	0	0	0	0	0					
Electrical Energy (271600)	12626	UNT-Units	0	0	0	0	0					
Powered by Ors OESIT) PSPCL											Print Date: 02-24-2024 09:08 PM	

Bill Rs 1,63,230-
 22 Jan 24
 to 22 Feb 24

Narend
 Principal
 G N Kh. College for Women,
 Model Town, LUDHIANA.
 26/2/24

WATER

AUDIT

WATER AUDIT

ABOUT COLLEGE

Over the course of its five fascinating decades, Guru Nanak Khalsa College for Women, Gujarkhan Campus, Model Town, Ludhiana, has fully accomplished the goal of expanding learning and critical thinking environments. This college is today recognized as a premier educational establishment that promotes intellectual and academic rigor, active extracurricular activities, community service projects, and civic engagement. In order to share the dynamic energy field, the institution offers a unique collection of tools that allow a community of enthusiastic teachers and talented students to join together to learn and grow.

It serves as a place for both teaching and group learning, which enhances the special bond between educators and learners. Despite its modest beginnings, the college currently boasts a variety of amenities, such as a state-of-the-art seminar room, Smart Class Rooms, separate buildings assigned to Arts and Commerce, well-equipped laboratories with internet and computer access, a gymnasium, and a fully functional library.

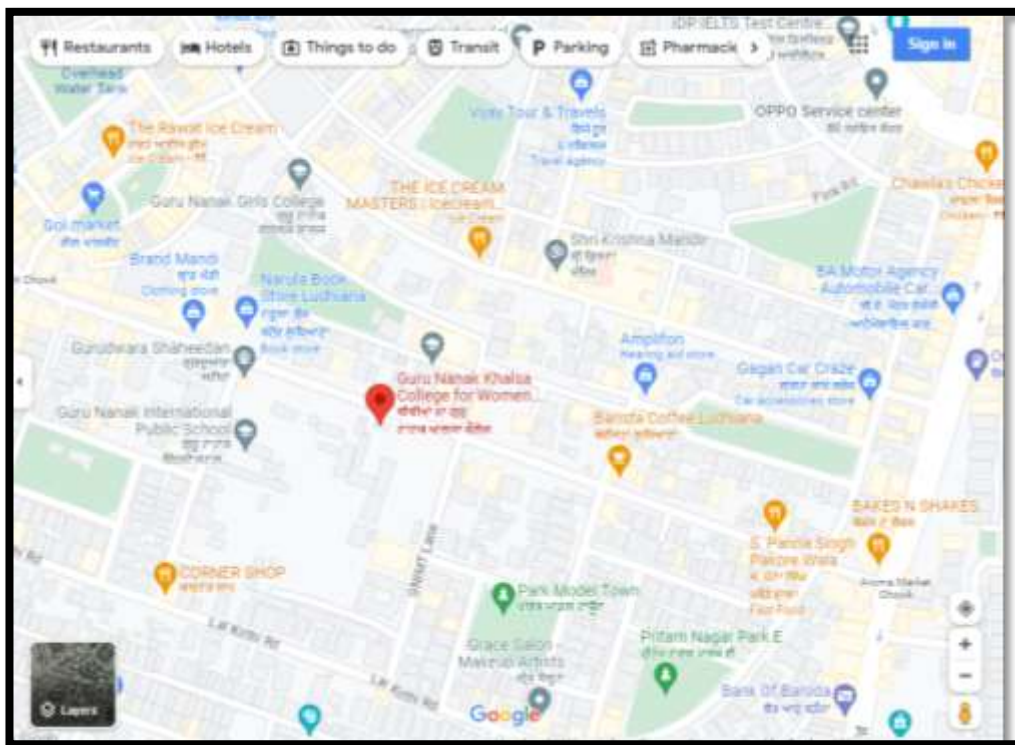

Figure: 1.1 - Image of Guru Nanak Khalsa college for Women from Google map

INSTITUTIONAL STRENGTHS

- ✓ Teaching staff with extensive training and expertise
- ✓ A blend of traditional and modern teaching methods and support for research initiatives
- ✓ Automated library and administrative block
- ✓ Infrastructure that is kept up to date, well-equipped labs
- ✓ A sizable, beautifully landscaped green space on a clean, green campus facilities that are environmentally friendly
- ✓ A geographical advantage

WATER AUDITING

An analysis of an entity's water usage is called a water audit. It rigorously examines every facet of use, beginning at the point when water enters the building and ending at the point where waste water is released. The audit determines the amount of water being used, its volume, any waste, any leaks, excessive use, etc., and pinpoints areas where consumption can be cut. It evaluates current treatment methods and systems critically and suggests adjustments to increase effectiveness and lower utilization.

An audit provides suggestions on how to decrease water usage and waste, enhance treatment procedures and techniques, and provide cost-benefit assessments based on this thorough investigation and observations. Additionally, it suggests that a system be established to record the quantity of water entering a system and to monitor its distribution and utilization (National Productivity Council, Govt of India).

Objectives

- To monitor the water use and conservation systems
- To evaluate the amount of water generation and its use, and its reduction inside the college.

Water audit committee

Name	Designation
Dr Kuldeep Kaur	Associate Professor
Ms. Shikha Kalra	Assistant Professor
Ms. Jaspreet Kaur	Assistant Professor
Ms. Amarpreet Kaur	Assistant Professor
Ms. Harpreet Kaur	Assistant Professor
Ms. Balwinder Kaur	Assistant Professor
Ms. Seema Devi	Assistant Professor

Target Areas of Water audit

This indicator addresses below areas related to water utilization.

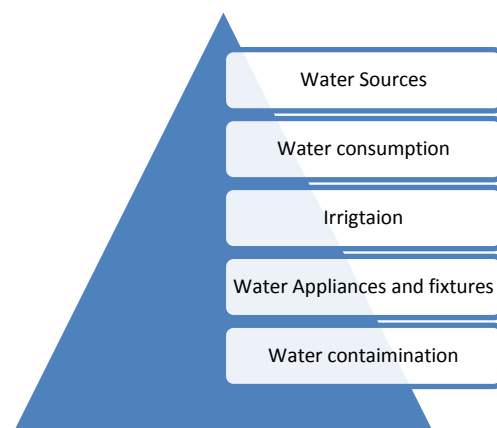

Step 1: Walk through survey

- Figuring for existing water sourcing, storage and distribution facility.
- Understanding the water demand and water utilization spheres.

Step 2: Secondary Data Collection

- Analyze water bills of past months

- Analyze Wastewater treatment scheme & costs etc.

Step 3: Conduction of Detailed Water Audit & Measurements

- Power measurement of pumps/motors
- Detection of potential leaks & water losses in the system
- Assessment of productive and unproductive usage of water
- Determine key opportunities for water consumption reduction, reuse & recycle.

Step 4: Preparation of Water Audit Report

- Documentation of collected & analyzed water balancing and measurement details
- Projects and procedures to maximize water savings and minimize water losses.
- Chances for water conservation based on reduce/ recycle/ reuse and rechargeoptions

FINDINGS

- ✓ The main source of water is government water supply.
- ✓ The water supply is 24x7 with underground and roof storage tanks.
- ✓ The reuse of potable water in form of grey water is used in mopping and floriculture options.
- ✓ There is also a provision of rain water harvesting and recharging system installed in the campus. This indicates management consciousness about ground water level and contributing in its own part towards artificial recharge.



- ✓ The sprinkler system is also installed for efficient use of water, minimizing its wastage.

WATER CONSUMPTION

The water consumption has been divided into two types of water: Potable and Non potable water

- ✓ Potable water consumption is in the following areas.
 1. Water cooler (Drinking water and R.O. system)
 2. Wash basins
 3. Canteen area
- ✓ Non -potable water is used in the following areas
 1. Washrooms
 2. Gardening area
 3. Static water tank

Details of Source of Fresh Water and Use Area

Details for Washroom		
Washroom	Taps	Type
Office	1 Wash Basin	Simple
	1 Toilet (English Seat)	Jet
	1 Flush	Handle Tab
Principal Room	1 wash Basin	
	1 Flush(English Seat)	One shower jet
	1 Shower	
Secretary Sir	1 wash Basin	One Tap
	1 Flush(English Seat)	Simple Jet
Ground floor girls with room	1 Wash Basin	
	1 Gate Wall	1 tap
	1 Toilet (English Seat)	Simple Jet Handle
	3 Toilet (Indian Seat)	3 tap
Staff Room	2 Wash Basin	
	1 Toilet (English Seat)	1 tap simple jet
	1 Toilet (Indian Seat)	2 tap
Second Floor girls washroom	2 Wash Basin	3 tap
	3 Toilet (English Seat)	3 simple jet
		2 tap
Hsc Lab	1 Wash Basin	1 tap
	1 Toilet (English Seat)	1 simple jet
Lib Staff Room	1 wash Basin	1 tap
	1 Toilet (Indian Seat)	
Commerce Dept. girls	2 Wash Room	2 simple jet
	2 Toilet (English Seat)	2 tap
	2 wash Basin	
Commerce Staff Room	1 Wash Basin	2 tap
	1 Toilet (English Seat)	1 simple jet

BCA dept. girls	2 Wash Room	2 tap
	2 Toilet (English Seat)	2 simple jet
	2 Was Basin	
BCA Staff Room	1 Wash Basin	2 tap
	1 Toilet (Indian Seat)	
MA Staff Room	1 Wash Basin	2 tap
	1 Toilet (Indian Seat)	
New Building	1 Wash Basin	2 tap
	2 Toilet (English Seat)	2 simple jet
Visitor Room	1 Wash Basin	2 tap
	1 Toilet (Indian Seat)	
Peon Washroom	1 Wash Basin	2 tap
	1 Toilet (Indian Seat)	

Maneeta

Dr. MANEETA KAHLON
Principal
G.N.Kh. College for Women
Gujarkhan Campus, Model Town,
Ludhiana

WATER BILLS

AMC

This AMC is between Ramesh Kumar , Sales and Service (Water filter and RO system) and GNKCW for the time period April-2023 to March-24 for maintenance of water coolers and filters installed in the campus and mandatory visit to the campus once in a month. For details the contact person is Mr.Ramesh Kumar.



Principal
Dr. MANBETA KAHLON
Principal
G.N.K. College for Women
Gejethan Campus, Model Town,
Ludhiana

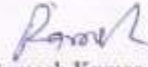

Ramesh Kumar

AMC OF WATER FILTERS

GURU NANAK KHALSA COLLEGE FOR WOMEN , GUJARKHAN CAMPUS

Model Town , Ludhiana

Water Filters in College

Area	Type	Capacity	AMC	AMC -2021	AMC -2022	AMC-2023	AMC-2024
Hostel (2)	Commercial	30 Ltr. In 1 hrs.	6500	13-09-2021	14-09-2022	15-09-2023 ✓	15.09.2024
Hostel (Old) S.F.	Commercial	30 Ltr. In 1 hrs.	No	No	No	No	No
Canteen (1)	Commercial	35 Ltr. In 1 hrs.	No	No	No	No	No
Domestic R.O.							
Area	No. Alloted	Capacity	AMC	AMC -2021	AMC -2022	AMC-2023	AMC-2024
Principal House	R.O.	15 Ltr. In 1 hrs.	No	Self	Self	Self	Self
Hostel Warden	R.O.	8 Ltr. In 1 hrs.	4200	04-08-2021	05-08-2022	05.08.2023	06.08.2024
Principal Pantry	R.O.	8 Ltr. In 1 hrs.	4200	02-11-2021	02-11-2022	02.11.2023	02.11.2024
Home Science Lab.	R.O.	8 Ltr. In 1 hrs.	4200	05-03-2021	06-03-2022	06.03.2023	06.03.2024
Simple Aquaguard							
Area	No. Alloted	Capacity	AMC	AMC -2021	AMC -2022	AMC-2023	AMC-2024
Block 1 (3rd Floor)	1	50 Ltr. In 1 hrs.	2400	15-09-2021	16-09-2022	16.09.2023	16.09.2024
Music Room	2	50 Ltr. In 1 hrs.	2400	14-04-2021	15-05-2022	15.04.2023	16.04.2024
Seminar Hall (2Unit)	3	50 Ltr. In 1 hrs.	2400	04-08-2021	05-08-2022	05.08.2023	06.08.2024
Home Science Lab	4	50 Ltr. In 1 hrs.	2400	21-09-2021	22-09-2022	22.09.2023	22.09.2024
Block 2 (3rd Floor)							
Commerce Deptt.	5	50 Ltr. In 1 hrs.	2400	04-08-2021	05-08-2022	05.08.2023	06.08.2024

Principal
 Dr. MANEETA KAHLON
 Principal
 G.N.Kh. College for Women
 Gujarkhan Campus, Model Town,
 Ludhiana

Prin

Co-ordinators :Water Management
 Dr.Kuldeep Kaur *Kuldeep Kaur*
 Mrs.Shikha Kalra *Shikha Kalra*

AMC OF 5 FILTERS

RAMESH KUMAR

Saheed Sukhdev Singh Nagar, Lohara, Ludhiana.

Contact No. + 91 9316832036, +91 99156 27776

Sale & Service all Kinds of Water Filter & R O System.

Date:	13 12 2023			
Name:	Guru Nanak Water College			
Address:	Model Town - Multigang			
Product:	PO RO	Model:	Partly RO only Distill	
No.	Particulars	Quantity	Rate	Amount
1	Display system + pipe check Pen	01	1850/-	1850/-
2				
3				
4				
5				
Total				
Service Charges				400/-
Grand Total				2250/-

Signature *Two Thousand Two Hundred Fifty only*

Ramesh

Ramesh

Sukhdev

WATER PURIFIER SERVICE BILL

RAMESH KUMAR

Saheed Sukhdev Singh Nagar, Lohara, Ludhiana.

Contact No. + 91 9316832036, +91 99156 27776

Sale & Service all Kinds of Water Filter & R O System.

Date: 25.07.2023

Name: Gurpreet Singh / Walsq College

Address: Model Town, Ludhiana

Product: Aquaguard Model: 572000 Precalor

Sr. No.	Particulars	Quantity	Rate	Amount
1	AMC one year	01	2400/-	2400/-
2	(commerce dept)			
3	Replament			
4	P.F. work pipe			
5				
	Total			
	Service Charges			
	Grand Total			2400/-

Signature Two Thousand Four Hundred only
AMC from 05.08.2023 to 04.08.2024
one year only

Sukhdev *Ramesh*

Aloneete

RAMESH KUMAR

Saheed Sukhdev Singh Nagar, Lohara, Ludhiana.

Contact No. + 91 9316832036, +91 99156 27776

Sale & Service all Kinds of Water Filter & R O System.

Date:	08.08.2023			
Name:	Gurpreet Singh (Gurpreet College)			
Address:	Model Town - Ludhiana			
Product:	Reverse Osmosis Filter	Model:	RO + U.V	
Sr. No.	Particulars	Quantity	Rate	Amount
1	AMC - one year			
2	(Swinger Hall)	01	2400/-	2400/-
3	AMC one year	01		
4	(Hostel Warden)	01	4200/-	4200/-
5				
	Total			
	Service Charges			
	Grand Total			6600/-

Signature

Six thousand six hundred only

AMC from 05.08.2023 to 04.08.2024

one year only

Gurpreet Singh

Ramesh

Maneeta

999

RAMESH KUMAR

Saheed Sukhdev Singh Nagar, Lohara, Ludhiana.

Contact No. + 91 9316832036, +91 99156 27776

Sale & Service all Kinds of Water Filter & R O System.

Date:	18.09.2023		
Name:	Gyry Nandan Kataria College		
Address:	model town Ludhiana		
Product:	Aarogya	Model:	cc. preq coalar
Sr. No.	Particulars	Quantity	Rate
1	AMC Total. Two yrs	02	2400/
2	(i) Home scint 1ab		
3	(ii) Rtock 1 - 3rd flur		
4			
5			
	Total		4800/
	Service Charges		
	Grand Total		4800/

Signature Maneda Four Thousand Eight Hundred or
Amc one year only

Ramesh

Received Cash
Ramesh

WATER ACCOUNTING & METERING SYSTEM

Suggestions

Some of the recommendations are:

- ❖ Develop and implement a strategy to cut down on water consumption while drafting the water management policy.
- ❖ Establish an ecological policy within the organization and set an example for resource conservation, recycling, and waste management practices.
- ❖ Promote government, foundations, and business involvement in interdisciplinary water conservation and sustainable development research, teaching, policymaking, and information exchange.
- ❖ Engage all pertinent parties using interdisciplinary approaches, collaborate to develop operations, outreach initiatives, research projects, and courses that promote an environmentally sustainable future.

GREEN

AUDIT

**GURU NANAK KHALSA COLLEGE FOR WOMEN
GUJARKHAN CAMPUS, MODEL TOWN, LUDHIANA**



**SUPPORTING DOCUMENT
(2023-24)**

**7.1.6 'Quality audits on environment and energy are regularly
undertaken by the institution'**

INTERNAL GREEN AUDIT

Dr. Maneeta Kahlon

Principal

Dr. MANEETA KHLON
Principal
G.N.Kh. College for Women
Gujarkhan Campus, Model Town,
Ludhiana

Mrs. Gagneet Pal Kaur

Incharge (Greenery Management)

INTRODUCTION:

The green audit aims to analyze environmental practices within and outside the college campuses, which will have an impact on the eco-friendly atmosphere. Green audit can be defined as systematic identification, quantification, recording, reporting and analysis of components of university environment. It was initiated with the motive of inspecting the effort within the institutions whose exercises can cause threat to the health of inhabitants and the environment. Through the green audit, a direction as how to improve the structure of environment and there are include several factors that have determined the growth of carried out the green audit.

1.1. NEED FOR GREEN AUDITING

Green auditing is the process of identifying and determining whether institutions practices are eco-friendly and sustainable. Traditionally, we are good and efficient users of natural resources. But over the period of time excess use of resources like energy, water, are become habitual for everyone especially, in common areas. Green audit regulates all such practices and gives an efficient way of natural resource utilization. In the era of climate change and resource depletion it is necessary to verify the processes and convert it in to green and clean one. Green audit provides an approach for it. It also increases overall consciousness among the people working in institution towards an environment.

1.2. GOALS OF GREEN AUDIT

University has conducted a green audit with specific goals as:

1. Identification and documentation of green practices followed by university.
2. Identify strength and weakness in green practices.
3. Analyze and suggest solution for problems identified.
4. Increase environmental awareness throughout campus
5. Identify and assess environmental risk.
6. Motivates staff for optimized sustainable use of available resources
7. The long-term goal of the Green Audit is to sensitize and make aware the stakeholders of the environment .

1.3. OBJECTIVES OF GREEN AUDIT

1. To examine the current practices of keeping the campus green.
2. To identify and analyze significant environmental issues.
3. Setup goal, vision, and mission for Green practices in campus.
4. Continuous assessment for betterment in performance in green belt of the campus.

1.4. BENEFITS OF GREEN AUDIT TO EDUCATIONAL INSTITUTIONS

There are many advantages of green audit to an Educational Institute:

1. It would help to protect the environment in and around the campus.
2. Recognize the cost saving methods through waste minimization and energy conservation.
3. Empower the organization to frame a better environmental performance.
4. The institution is known in Ludhiana as “fullan vala college” for the lush green lawns it maintains.
5. It is worth mentioning here that the college has maintained more than 1000 pots in which seasonal flowers are grown during every season.

2. OBJECTIVE AND SCOPE

The broad aims/benefits of the eco-auditing system would be

- Environmental education through systematic environmental management approach
- Improving environmental standards
- Benchmarking for environmental protection initiatives
- Sustainable use of natural resource in the campus.
- Financial savings through a reduction in resource use
- Curriculum enrichment through practical experience
- Development of ownership, personal and social responsibility for College campus and its environment
- Enhancement of College profile
- Developing an environmental ethic and value systems in young people.

A Green Audit is a study of the greenery utilization of the campus. It takes a lot of effort on the part of the Greenery Management Team as well as the highly skilled gardeners of the

college to maintain greenery in the campus. A green audit is the method of ensuring that the Green Belt of the college has been preserved and taken care of in the best manner.

MEMEBERS OF THE GREENERY COMMITTEE

Internal Green Audit was carried out by Greenery Management team under which tree count of the college was conducted and the area under green belt was measured. Committee for Green Audit includes:

Mrs. Gagneet Pal Kaur

Mrs. Sukhjit Kaur

Mrs. Inderjit Kaur

Ms. Shalini

GLIMPSES INTO THE TREE DIVERSITY OF THE COLLEGE CAMPUS

SR.NO	NAME OF THE PLANT	SCIENTIFIC NAME	LOCATION	USES
1	Bach	<i>Acorns colurna</i>	College Herbal Garden	Remedies for many conditions, including anxiety, depression, stress, emotional and physical trauma, cancer, and HIV.
2	Vasaka	<i>Adhatoda vasaca</i>	College Herbal Garden	The plant has manifold curative properties and is an ultimate remedial measure for a lot of health anomalies like breathing trouble, cough, and cold, nasal congestion, sore throat, asthma, bronchitis, other upper respiratory tract infections, bleeding disorders.
3	Aloe	<i>Aloe vera</i>	College Herbal Garden	Aloe vera creams, gels, and ointments contain the clear gel found in aloe vera leaves. These products can be applied topically to treat various skin conditions.
4	Kalmegh	<i>Andrographis paniculata</i>	College Herbal Garden	Used traditionally for the treatment of diseases such as cold, fever, diabetes, hypertension, ulcer, bronchitis, skin diseases, diarrhea, and malaria.
5	Satawar	<i>Asparagus spp.</i>	College Herbal Garden	It's also an adaptogenic herb. Adaptogenic herbs are said to help your body cope with physical and emotional stress.
6	Brahmi	<i>Bacopa monnieri</i>	College Herbal Garden	Brahmi is used for Alzheimer's disease , improving memory, anxiety, attention deficit-hyperactivity disorder (ADHD), allergic conditions, irritable bowel syndrome, and as a general tonic to fight stress.
7	Vajradanti	<i>Barleria prionitis</i>	College Herbal Garden	Vajradanti is why it is used for cough and allergic rhinitis. Often, the juice of the leaf is given along with honey to promote the expulsion of phlegm and provide a soothing effect.

8	Karaunda	<i>Carissa carandas</i>	College Herbal Garden	Immense health benefits, such as preventing heart disease, relieving digestive trouble and curing fevers.
9	Safed musli	<i>Chlorophytum spp.</i>	College Herbal Garden	It is used in traditional systems of medicine including Ayurveda, Unani, and homeopathy. People use safed musli for athletic performance, obesity, erectile dysfunction (ED) , and other conditions.
10	Coleus	<i>Coleus forskohlii</i>	College Herbal Garden	Coleus was used for numerous purposes including treatment of rashes, asthma, bronchitis, insomnia, epilepsy, and angina . Coleus is thought to act much like theophylline and has been studied as an effective bronchodilator.
11	Gugal	<i>Commiphora wightii</i>	College Herbal Garden	Guggul gum resin is used for arthritis , lowering high cholesterol, "hardening of the arteries" (atherosclerosis), acne and other skin diseases, and weight loss.
12	Insulin plant	<i>Costus igneus</i>	College Herbal Garden	Consumption of the leaves are believed to lower blood glucose levels , and diabetics who consumed the leaves of this plant said to have a fall in their blood glucose levels.
13	Haldi(Mixture)	<i>Curcuma longa</i>	Commerce Block	Curcumin is proven to have anti-inflammatory and immune-boosting properties.
14	Lemon grass	<i>Cymbopogon flexuosus</i>	College Herbal Garden	Lemongrass is used for treating digestive tract spasms, stomachache, high blood pressure, convulsions, pain, vomiting, cough , achy joints (rheumatism), fever, the common cold, and exhaustion.
15	Gudmar	<i>Gymnema sylvestre</i>	College Herbal Garden	The leaves of gudmar are imbued with gymnemic acids, a potent bioactive compound that acts to suppress the taste of sugar by interacting with taste receptors on the tongue, thereby valued as a sugar destroyer and used extensively in the treatment of diabetes.

16	Motia	<i>Jasminum sambac</i>	College Herbal Garden	It is also commonly known as jasmine sambac, Palmarosa oil, and Motia. Due to high medicinal property of Motia Attar, it is often used for the treatment of Asthma and similar sensitivities.
17	Jamalghota	<i>Jatropha gossypifolia</i>	College Herbal Garden	It has potent effects, which results in cramps during defecation and loose stools. Generally, Jamalghota is not indicated in most cases of constipation because of its dangerous effects.
18	Kitchen mint	<i>Mentha viridis</i>	College Herbal Garden	Use as a garnish for cool drinks and fruit desserts. Use dried peppermint leaves, added to boiling water to make a refreshing and digestive tea. Make a yoghurt dressing with chopped mint leaves, natural yoghurt, garlic and salt and pepper for salads especially cucumber salad.
19	Lajwanti	<i>Mimosa pudica</i>	College Herbal Garden	The roots of lajwanti are used to treat leucoderma, angiopathy, metropathy, ulcers, dysentery, swellings, jaundice, bronchial asthma, small pox, strangury, and fevers. Its leaves are useful in hydrocele, hemorrhoids, fistulous withers, scrofula, pinkeye, cuts and bleeds.
20	Curry patta	<i>Murraya koenigii</i>	College Herbal Garden	Curry leaves are widely used in the Indian kitchens in curries, rice, snacks, et al. They are known for their aromatic and distinctive flavour; however, they have more than just appetite-tickling flavour. These leaves are said to have various health and beauty benefits to offer. Curry leaves are herbs that are known to have essential nutrients that help in conditions like weight loss, blood pressure, indigestion, anaemia, diabetes, acne, hair loss.

26	Akarkara	<i>Spilanthes acmella</i>	College Herbal Garden	Akarkara is widely used to treat indigestion as it effectively enhances the secretion of saliva and digestive enzymes, which aids in better digestion. Indigestion occurs when the kapha levels in a body are elevated and cause a state of agni mandya or a weak digestive fire.
27	Bahera	<i>Terminalia bellirica</i>	College Herbal Garden	<i>Terminalia bellerica</i> is used to protect the liver and to treat respiratory conditions, including respiratory tract infections, cough, and sore throat. <i>Terminalia chebula</i> is used for dysentery. <i>Terminalia bellerica</i> and <i>Terminalia chebula</i> are used as a lotion for sore eyes.
28	Giloe	<i>Tinospora cordifolia</i>	Main College Lawn	All parts of this plant are thought to have health benefits. People have long used it to treat a wide range of issues, including fever, infections, diarrhea, and diabetes .
29	Ajowain	<i>Trachyspermum ammi</i>	College Herbal Garden	"Carom seeds help in maintaining your digestive health. They treat any kind of abdominal discomfort due to indigestion like stomach pain or burning sensation. It increases the appetite for those suffering from loss of appetite."
30	Anantmool	<i>Tylophora indica</i>	College Herbal Garden	According to this shalok anantmool is sweet, unctuous, and heavy and used to improve quality of sperm. It is used to treat various disorders like indigestion, asthma, cough, fever, dysentery, poisoning and menorrhagia .
31	Sadabahar	<i>Vinca rosea</i>	College Herbal Garden	The bulk of active constituents in this flower offers an ultimate remedy for treating respiratory disorders like asthma, bronchitis, COPD, cough and cold symptoms .
32	Nirgundi	<i>Vitex negundo</i>	College Herbal Garden	Nirgundi, also called a five-leaved chaste tree, is a potent ayurvedic plant, that possesses noteworthy therapeutic properties and heals several ailments including asthma, muscle spasms and anxiety.

33	Ashwagandha	<i>Withania somnifera</i>	College Herbal Garden	Ashwagandha contains chemicals that might help calm the brain, reduce swelling, lower blood pressure, and alter the immune system.
34	Kinnow	<i>Citrous Nobilis</i>	College Ground	Aids Digestion. One of the best qualities of kinnows is that it absorbs into stomach and helps in digestion without putting any pressure on the digestive tract
35	Orange	<i>Sinensis</i>	College Ground	They are a good source of vitamin C , as well as several other vitamins, minerals, and antioxidants. For this reason, they may lower your risk of heart disease and kidney stones.
36	Amla	<i>Phyllanthus Emblica</i>	College Ground	Regular intake of amla not only leads to a healthy and glowing skin but also improves eye sight, boosts the immune system, and regulates blood sugar and lipids. Eat as murabba, pickles or candies; but consume it daily.
37	Guava	<i>Psidium Guajava</i>	College Ground	Various parts of the plant, including the leaf and the fruit, are used as medicine. People use guava leaf for stomach and intestinal conditions, pain, diabetes, and wound healing . The fruit is used for high blood pressure.
38	Anjeer Fig	<i>Ficus Carcia</i>	College Ground	Anjeer is a powerhouse of minerals like zinc, manganese, magnesium, iron and thus promotes reproductive health . The high concentration of antioxidants and fibre in this dry fruit protects against hormonal imbalances and post-menopausal issues.
39	Papaya	<i>Carica Papaya</i>	College Ground	The leaves are used to make medicine. Papaya is used for preventing and treating gastrointestinal tract disorders , intestinal parasite infections, and as a sedative and diuretic. It is also used for nerve pains (neuralgia) and elephantoid growths.

40	Jamun	<i>Syzygium Cumini</i>	College Ground	This fruit packs a punch as it has a high antioxidant content, contains diuretic, and has antibacterial and antiscorbutic properties.
41	Neem	<i>Azadirachta Indica</i>	Basket Ball Ground	Neem leaf is used for leprosy , eye disorders, bloody nose, intestinal worms, stomach upset, loss of appetite, skin ulcers, diseases of the heart and blood vessels (cardiovascular disease), fever, diabetes, gum disease (gingivitis), and liver problems. The leaf is also used for birth control and to cause abortions.
42	Tali	<i>Erythrophleum Suaveolens</i>	Basket Ball Ground	Taken as a snuff to relieve headache , as a remedy for other pains and fever, and to cure lung sickness in cattle. The bark has been used as ordeal poison in the same way as <i>Erythrophleum suaveolens</i> , and is also used as a fish and rat poison.
43	Satpatia	<i>Alstonia Scholaris</i>	Basket Ball Ground	The bark is known as ditabark, used by Indians as traditional medicine to treat diarrhoea, dysentery, asthma, and a few types of fevers. It has also been used as an aphrodisiac. When damaged, the bark lets out a sticky milky latex, which is also valued for its medicinal properties.
44	Imli	<i>Tamarindus Indica</i>	Basket Ball Ground	It is also used for constipation, fever, gallbladder disorders, disorders affecting bile flow in the liver, and many other conditions, but there is no good scientific evidence to support these other uses.
45	Deg	<i>Diethylene Glycol</i>	Basket Ball Ground	Commonly used in the commercial preparation of antifreeze, brake fluid, cigarettes, and some dyes. It is an excellent solvent for many relatively insoluble substances.
46	Fox Tail Palm	<i>Wodyetia Bifurcata</i>	Basket Ball Ground	It really does depend on what kind of palm it comes from. The Foxtail palm's fruit is toxic to us and the every part of the sago palm is poisonous to us and animals.

47	Ashoka	<i>Saraca Asoca</i>	Basket Ball Ground	The seed, bark and flowers of Ashoka are mainly used for in menorrhagia, astringent, Diabetes, biliousness, dyspepsia, ulcers and can also be used as uterine stimulant, estrogenic effects, abortifacient.
48	Mulberry	<i>Morus Alba</i>	Basket Ball Ground	Some people place sheets or other materials around mulberry trees to catch the berries as they drop. This makes them quick to collect. While they're often eaten raw, mulberries can also be used to make jams, preserves, pies, and a variety of other delicious treats.
49	Pilken	<i>Ficus Spp.</i>	College Ground	One of the most common uses for bee pollen is the management of seasonal allergies , such as hay fever. It's thought that ingesting pollens will help the body to build resistance to these potential allergens and, in turn, reduce allergy symptoms.
50	China Palm	<i>Livistona Chinensis</i>	Commerce Block	The Chinese fan palm is primarily cultivated for its ornamental value , given its beauty and cold-hardiness.
51	Money Plant	<i>Epipremnum Aureum</i>	Commerce Block	Growing a money plant in the house brings positive energy . Along with this, happiness and prosperity come in the house and the inflow of money increases.
52	Champa	<i>Magnolia Figo</i>	Near Main Gate	Champaka tree rich in medicinal properties is used in several ayurvedic preparations. The leaves, root, root bark, flowers, fruit and oil are used for its medicinal value. The extract of the flowers, leaves and seeds have anti cancer, antimicrobial, antioxidant properties.

Maneeta
Dr. Maneeta Kahlon
Principal

Parveen Arora
Dr. Parveen Arora
Nodal Officer (SAP)

Gagneet Pal Kaur
Mrs. Gagneet Pal Kaur
(Co-ordinator)
SAP - Greenery Management

TOTAL AREA OF GNW CAMPUS

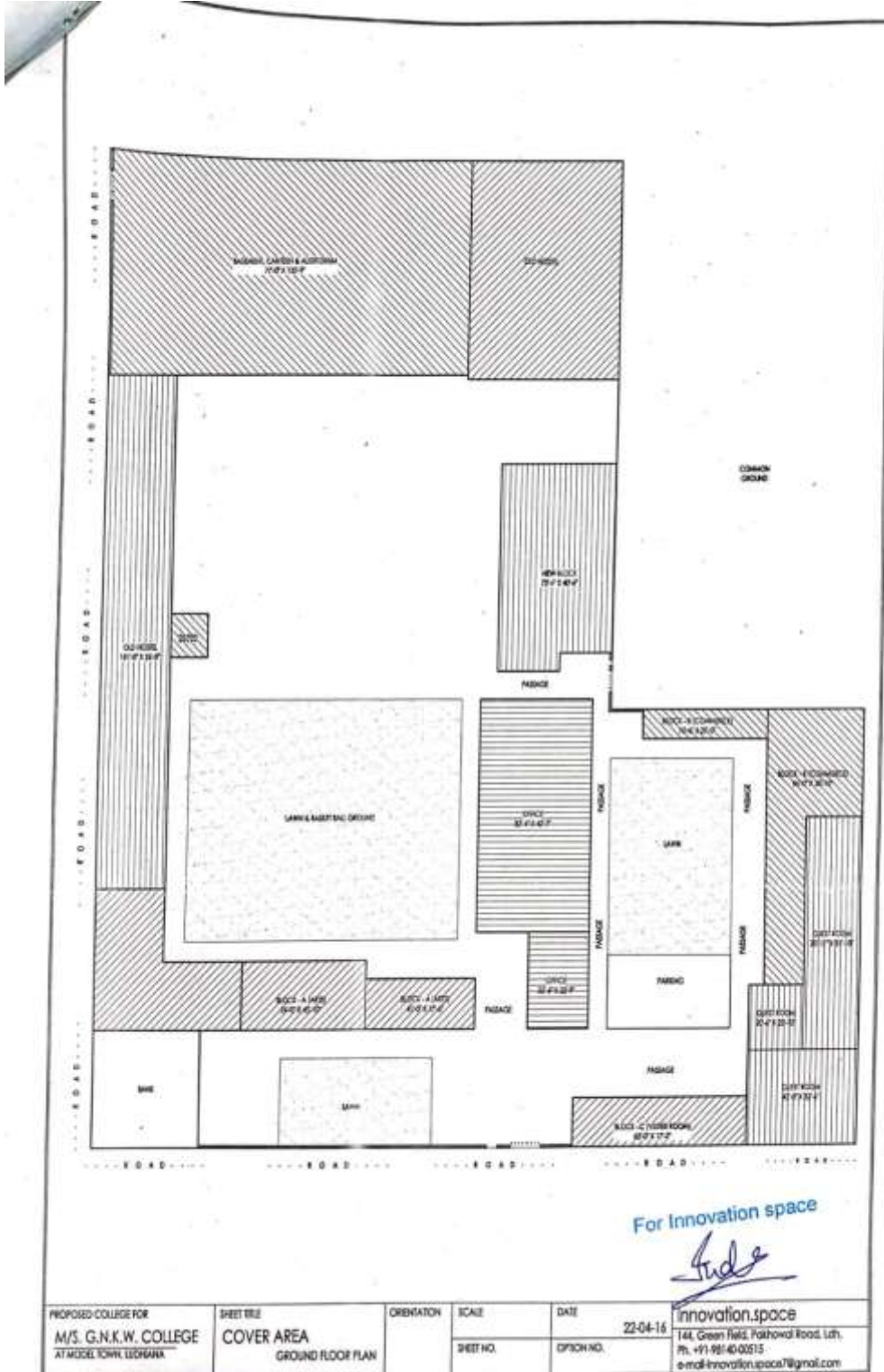

PROPOSED COLLEGE FOR M/S. G.N.K.W. COLLEGE AT MODEL TOWN, DEHRADUN	SHEET TITLE COVER AREA GROUND FLOOR PLAN	ORIENTATION	SCALE	DATE 22-04-16	INNOVATION SPACE 144, Green Field, Pathokhal Road, Lohi, Ph. +91 98140 00515 email-innovation.space7@gmail.com
			SHEET NO.	OPTION NO.	

TOTAL GREEN COVERAGE AREA OF THE COLLEGE CAMPUS

Total Area of the Trust = 12 Acres
 Total College Area = 2.5 Acres

① Humanities Block
 Green Area. $51 \times 38 = 1938$ sq ft
 Entrance Lawns
 38 Breadth

② Green Area Lawns
 Surrounded by classrooms
 Humanities Block
 $112 \times 85 = 9520$
 85B

③ Green Area Lawns
 Commerce Block.
 $95 \times 52 = 4940$
 95B

Total Green Area within the Campus = 16398

④ Common Play Ground of
 GNW's, GNIPS, GNIMT = 500 MTRS x 500 MTRS
 + GNKR High School (Girls + Boys)
 250000
 $250000 / 39.68 = 6.177$ Acres

GREEN CAMPUS VIEW OF THE COLLEGE





RECOMMENDATIONS

Following are some of the key recommendations for improving campus environment:

1. An environmental policy document has to be prepared with all the recommendations and

current practices carried by the college.

2. A frequent visit should be conducted to ensure that the generated waste is measured, monitored and recorded regularly and information should be made available to administration. Seasonal fruits and flowers should be planted as and when required.
3. Drip System should be installed to avoid wastage and leakage of water.
4. Student oriented activities to inculcate love for nature among them should be conducted.

Although the need for external Green Audit was felt, this will be a comprehensive document which will be done within the next session by an external agency which will serve as a guide for next three years.